

TECHNICAL SPECIFICATION

Hurdle cart for competition hurdles

HC-23



File: 2013-11-18

PRODUCT SUPPORT
Paweł Ciechanowski
p.ciechanowski@polanik.com

Contents

| Chapter | Page |
|--------------------------------|------|
| I. General description and use | 2 |
| II. Technical specification | 3 |
| III. Assembly | 4 |
| IV. Operation and maintenance | 4 |
| V. Packing and transport | 4 |

I. General description and use

HC-23 has got a durable aluminium construction, anodized in silver colour. It is equipped with an ergonomic handle and a catch for electric truck shaft.

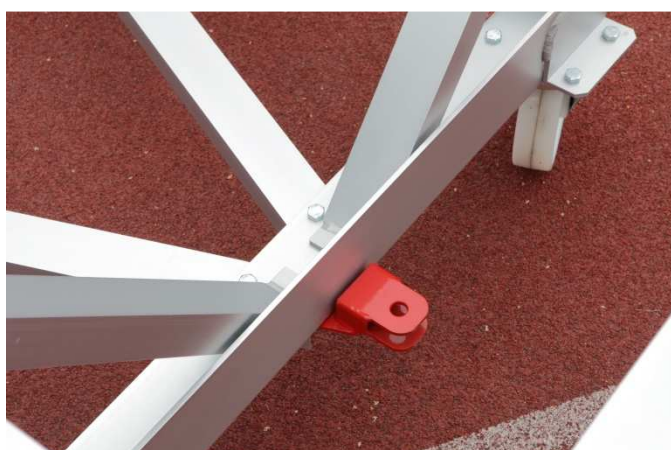

HC-23 © 2013 Polanik Sp. z o. o. The producer reserves the right to introduce without warning changes in product constructions and colours.

NIP 7712594181, KRS 0000156204, REGON 592201398

II. Technical specification

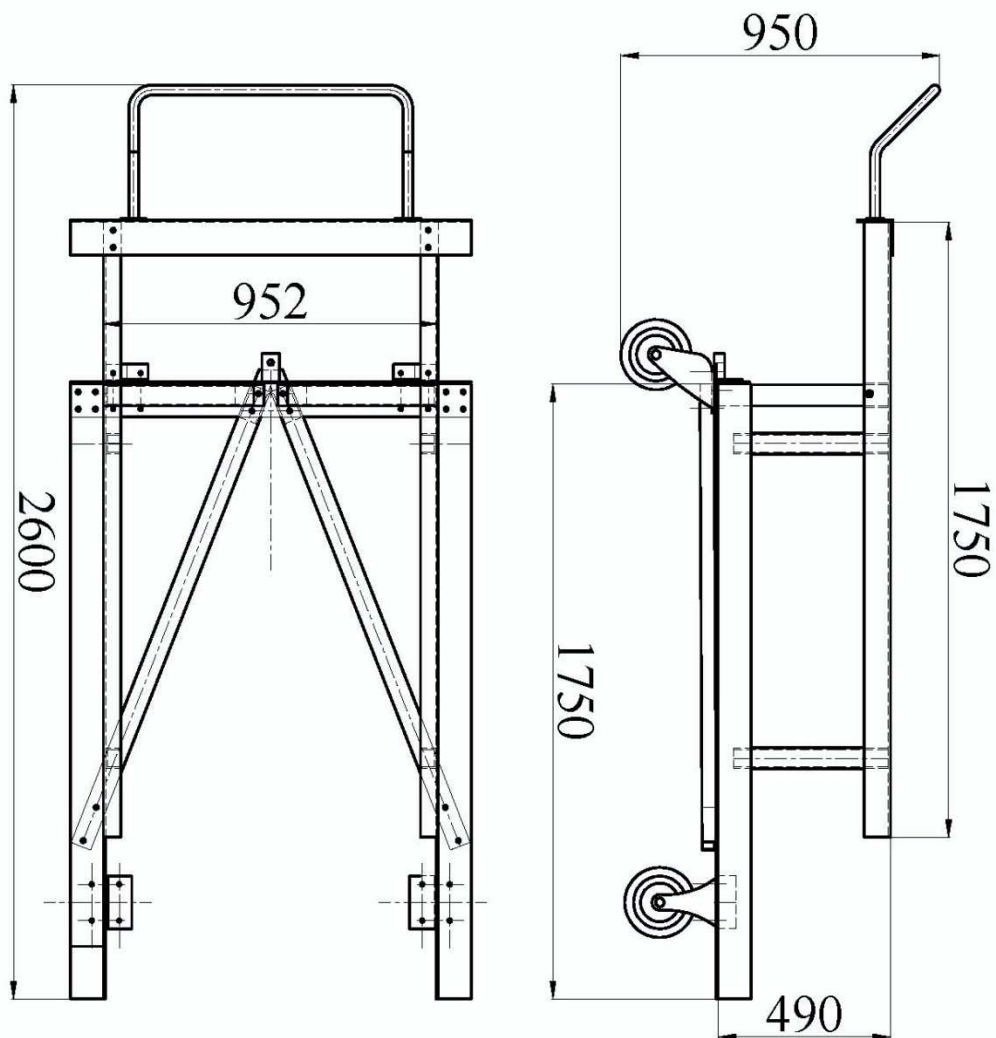

[mm]

| | |
|-----------------------|--|
| Code | HC-23 |
| Type | aluminium, anodized |
| Use on | synthetic track, concrete and asphalt |
| Capacity | 20 pcs of PP-170 and 28 pcs of PP-171/PP-173 |
| Handle | included |
| Catch for truck shaft | included |
| Net weight [kg] | 60 |

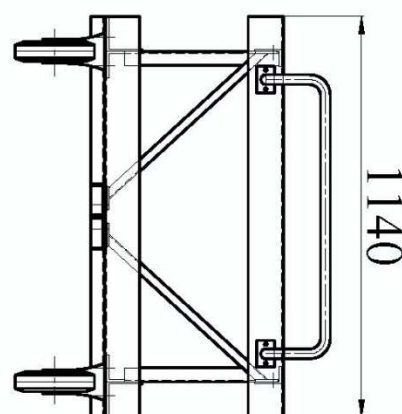

NIP 7712594181, KRS 1414347830

III. Assembly

The cart is delivered in parts. Please assemble the cart according to the drawing below:

| Assembly drawing HC-23 | | M10x30 | M10x25 | M8x20 | M10x25 | M10 | M8 | O10.5 | O8.5 |
|------------------------|------|--------|--------|--------|--------|-----|--------|-------|------|
| Item | Q-ty | 4 | 12 | 4 | 22 | 38 | 4 | 38 | 4 |
| 1 | 1+1 | Item 7 | | Item 6 | - | - | Item 6 | - | - |
| 2 | 2 | | | | | | | | |
| 3 | 2 | | | | | | | | |
| 4 | 1 | | | | | | | | |
| 5 | 1 | | | | | | | | |
| 6 | 1 | | | | | | | | |
| 7 | 1 | | | | | | | | |
| 8 | 4 | | | | | | | | |

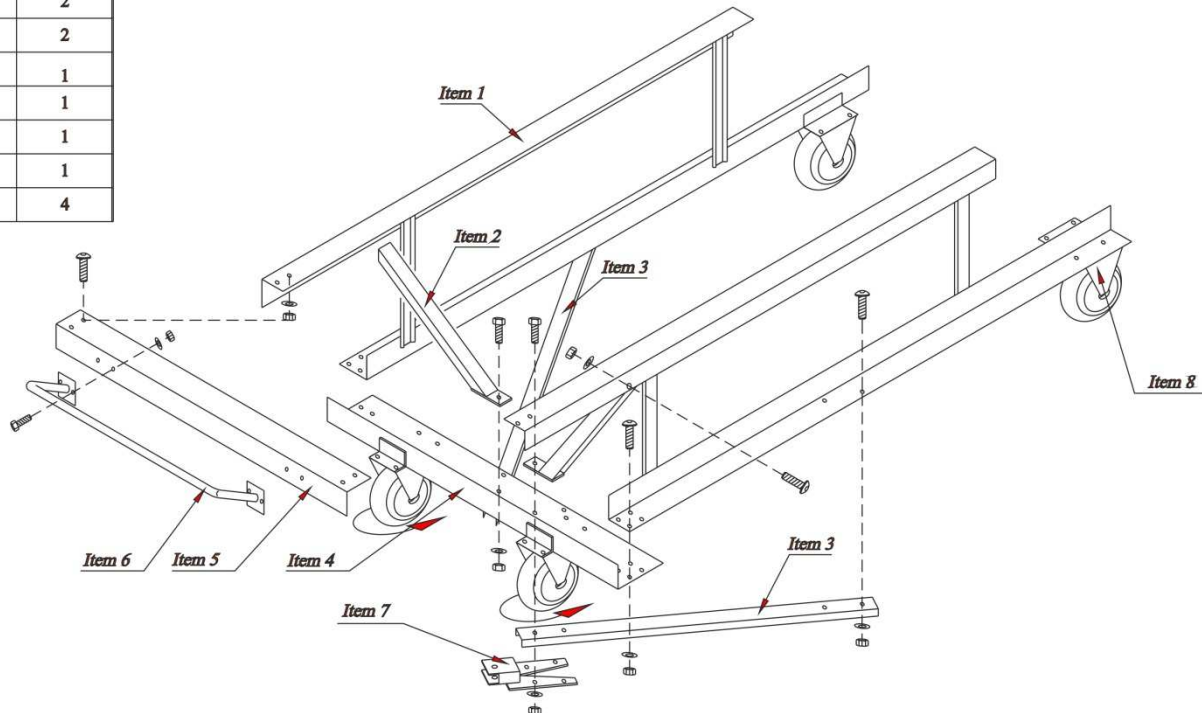

IV. Operation and maintenance

The cart must be stored in a roofed and dry place. The wheel excels should be greased once a year.

V. Packing and transport

The cart is packed in a case:

| | | |
|---------------------------|----------|------|
| Box's dimensions [m] | contents | 1 pc |
| | length L | 2,32 |
| | width B | 0,42 |
| | height H | 0,55 |
| Volume [m ³] | | 0,54 |
| Gross weight [kg] | | 80 |