

POLANIK
Poland, Życzliwa 11
97-300 Piotrków Trybunalski

tel. +48 44 646 44 81
tel. +48 44 648 50 89
fax +48 44 646 43 58

e-mail: info@polanik.com
www.polanik.com



USER MANUAL Self-assembly garages for PV landing areas

GT



File: 2014-07-18
PRODUCT SUPPORT
Paweł Ciechanowski
p.ciechanowski@polanik.com

Thank you for choosing Polanik garages.

Contents

Chapter	Page
I. General description and use	2
II. Parts list	3
III. Assembly	4
IV. Operation	35
V. Maintenance	35

I. General description and use

The garage is designed to protect the landing area which is placed on the platform and sheltered with the waterproof cover outdoors. Main features:

Excellent protection

- against unfavourable weather conditions and mechanical damages,
- garage bottom parts are equipped with PCV flaps to protect inside against animals,
- special pads made of polyethylene foam on the roof edges protect against injuries from accidental collisions with the garage,
- garage sloping roof assures free water and snow outflow,
- spacious structure ensures a proper clear space between the inside construction and the landing area, what minimize the risk of damages while opening and closing the garage,
- screws used for roof installation are equipped with rubber washers for better insulation,
- each segment is equipped with rubber gaskets which seal the inside of the garage after closing the padlock clams.

Easy self-assembly

- segment elements are screwed together with metric screws M10 80 mm and M8 80 mm only, without riveting or welding.

Easy and fast operating

- mobile segments designed for going over the landing area from the front and the back,
- segments are linked with padlock clams,
- special handles and build-in castoring wheels allow for easy manoeuvring.

High quality and durability

- supporting galvanized structure is made of high class welded steel profiles 30x30x2mm,
- construction is covered with 0,5 mm trapezoidal, aluminium and zinc sheets,
- garage elements are carefully linked together according to the rules which provide long lasting product life.

II. Parts list

The garage parts have got labels for easy identification, see below.



The parts are marked as follows:

Label	Description	Quantity
A1	Side wall with wheels	2 pcs
A2	Side wall with wheels	2 pcs
A3	Side wall with wheels and seal	2 pcs
B1	Top wall	1 pcs
B2	Top wall	1 pcs
B3	Top wall	1 pc
B4	Top wall	1 pc
C1	Frame	10 pcs
C2	Frame	4 pcs
C3	Crossbar	2 pcs
C4	Catch	2 pcs
C5	Crossbar	1 pc
D1	Roof slope	1 pc
D2	Roof slope	1 pc
E1	Roof slope	1 pc
E2	Roof slope	1 pc
F1	Roof slope with seal	1 pc
F2	Roof slope with seal	1 pc
J1	Roof slope with seal	1 pc
J2	Roof slope with seal	1 pc
H1	Roof slope	1 pc
H2	Roof slope	1 pc
K1	Roof slope	1 pc
K2	Roof slope	1 pc
G1	Ridge tile	1 pc
G2	Ridge tile	1 pc
G3	Ridge tile	1 pc
G4	Roof work	1 pc
G5	Roof work	1 pc
G6	Roof work	1 pc
G7	Roof work	1 pc

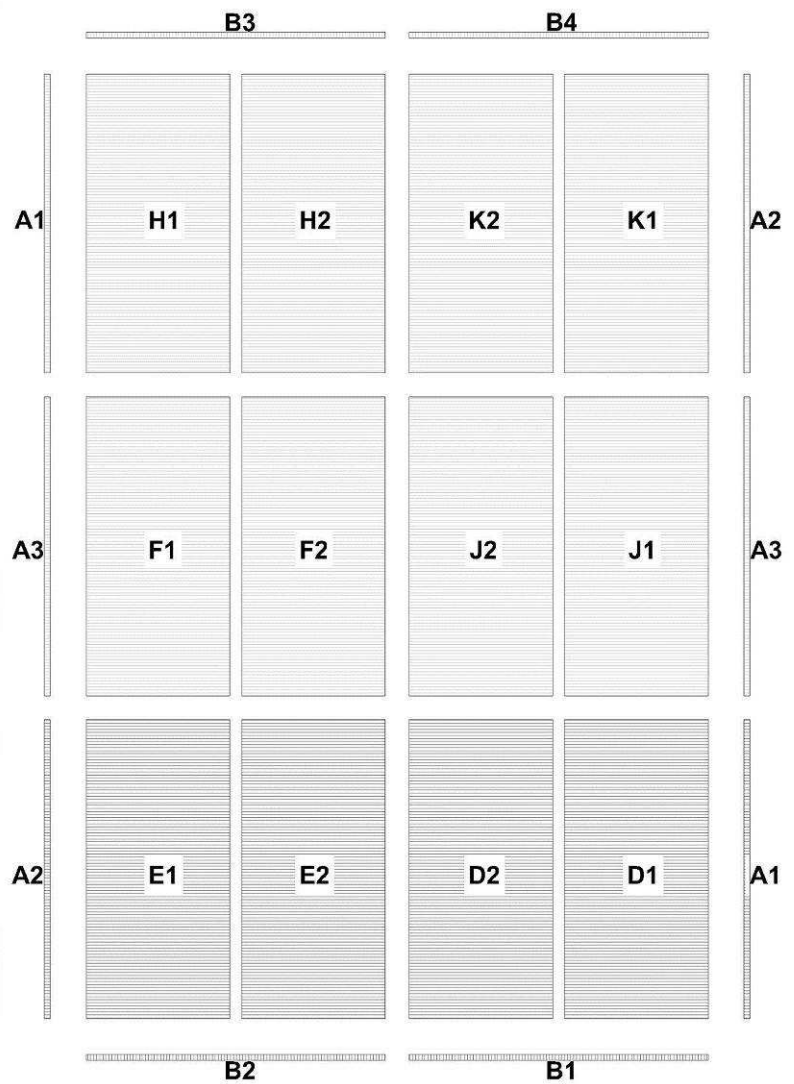

The set also includes screws (M10 80mm and M8 80mm) and plastic quick assembly rivets.

III. Assembly

To be sure that all the elements fit each other the garage is assembled and disassembled before it leaves the plant. The stages of the assembly is presented in the drawings.

Stage I

The garage is divided into three segments. Start the assembly from one part of the garage. The parts are marked out on the schemes with red colour to avoid problems with their fitting. All elements should be fitted according to the enclosed schemes in the proper order. At the stage of the construction all the screws should be installed only with hands, do not use spanners.

Stage II

When the part of the garage is completely assembled you can firmly screw down all the screws with spanners and rivet the ridge tile. Follow the schemes and do the same with the rest of the segments.

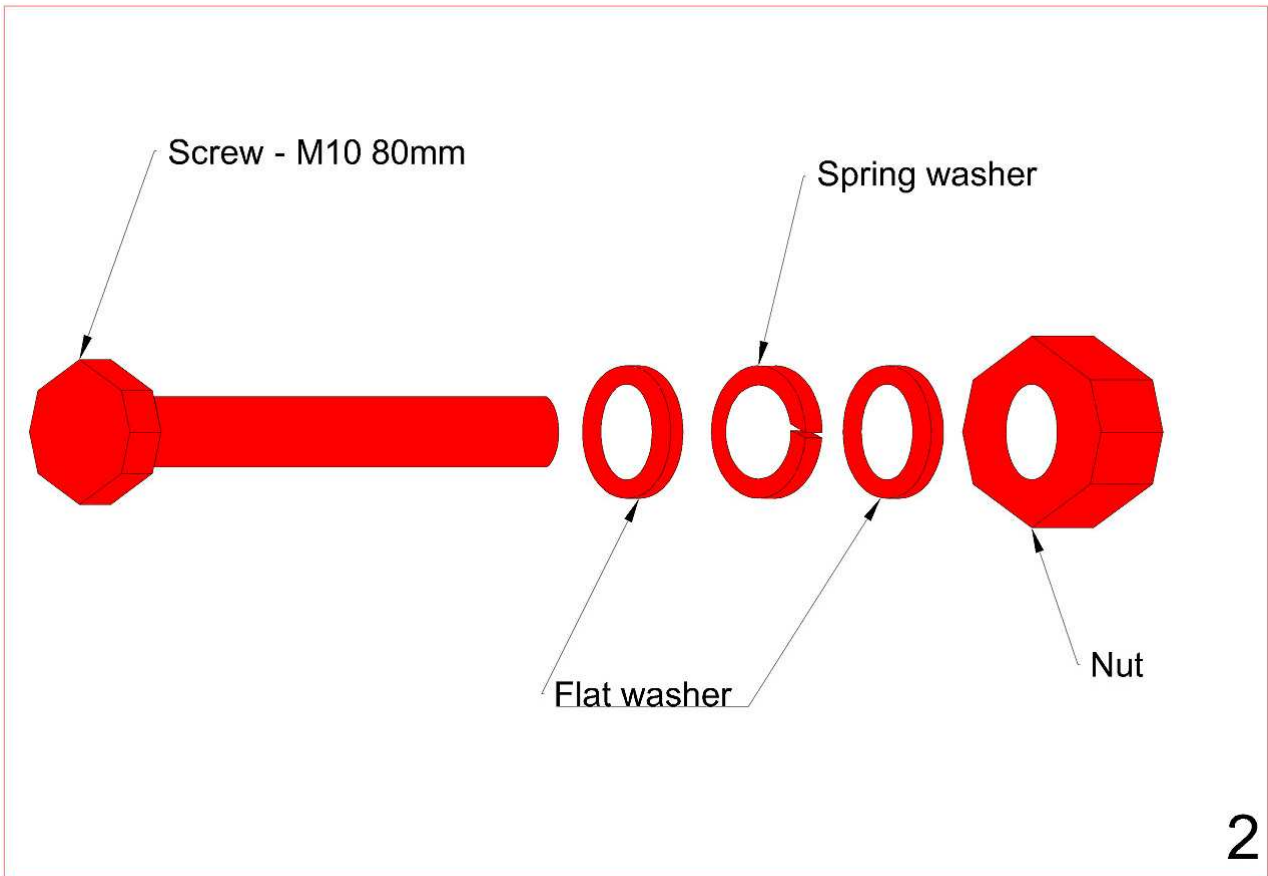
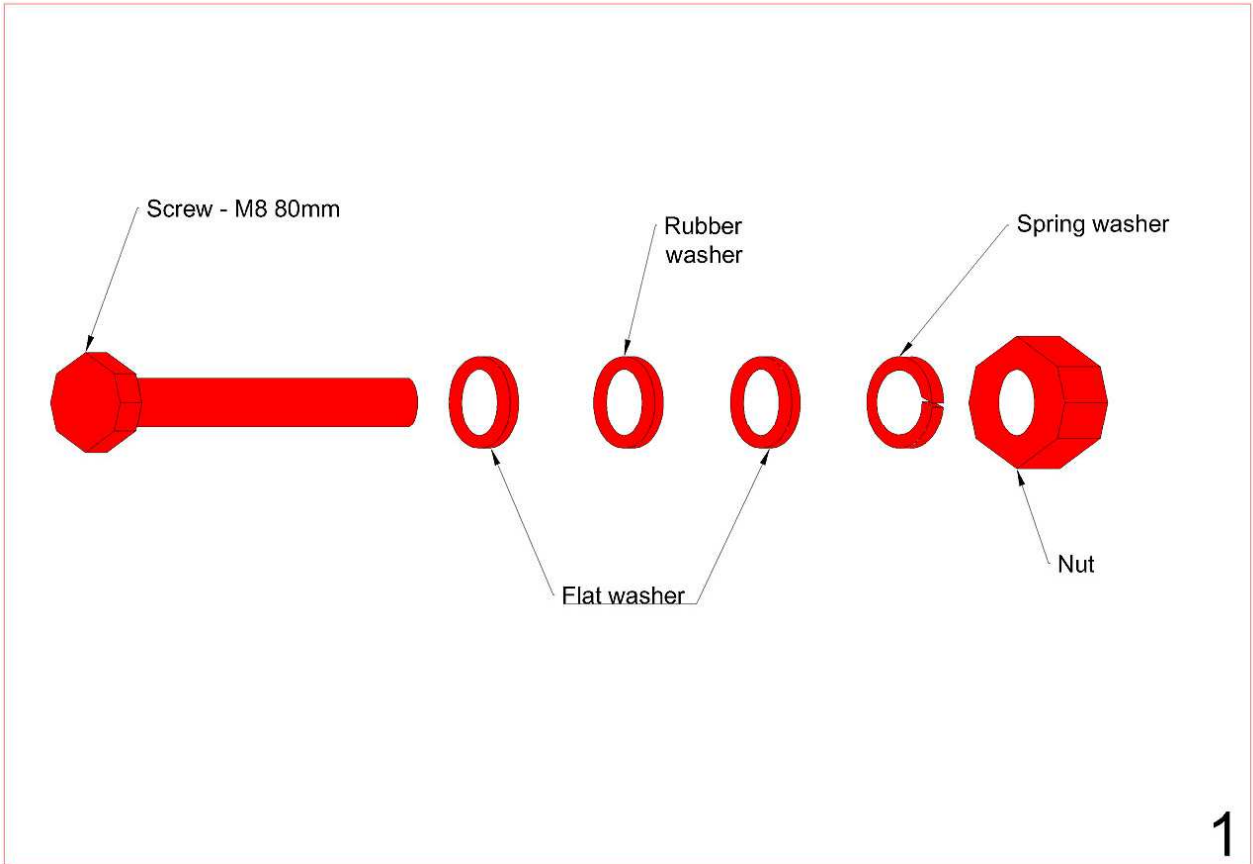

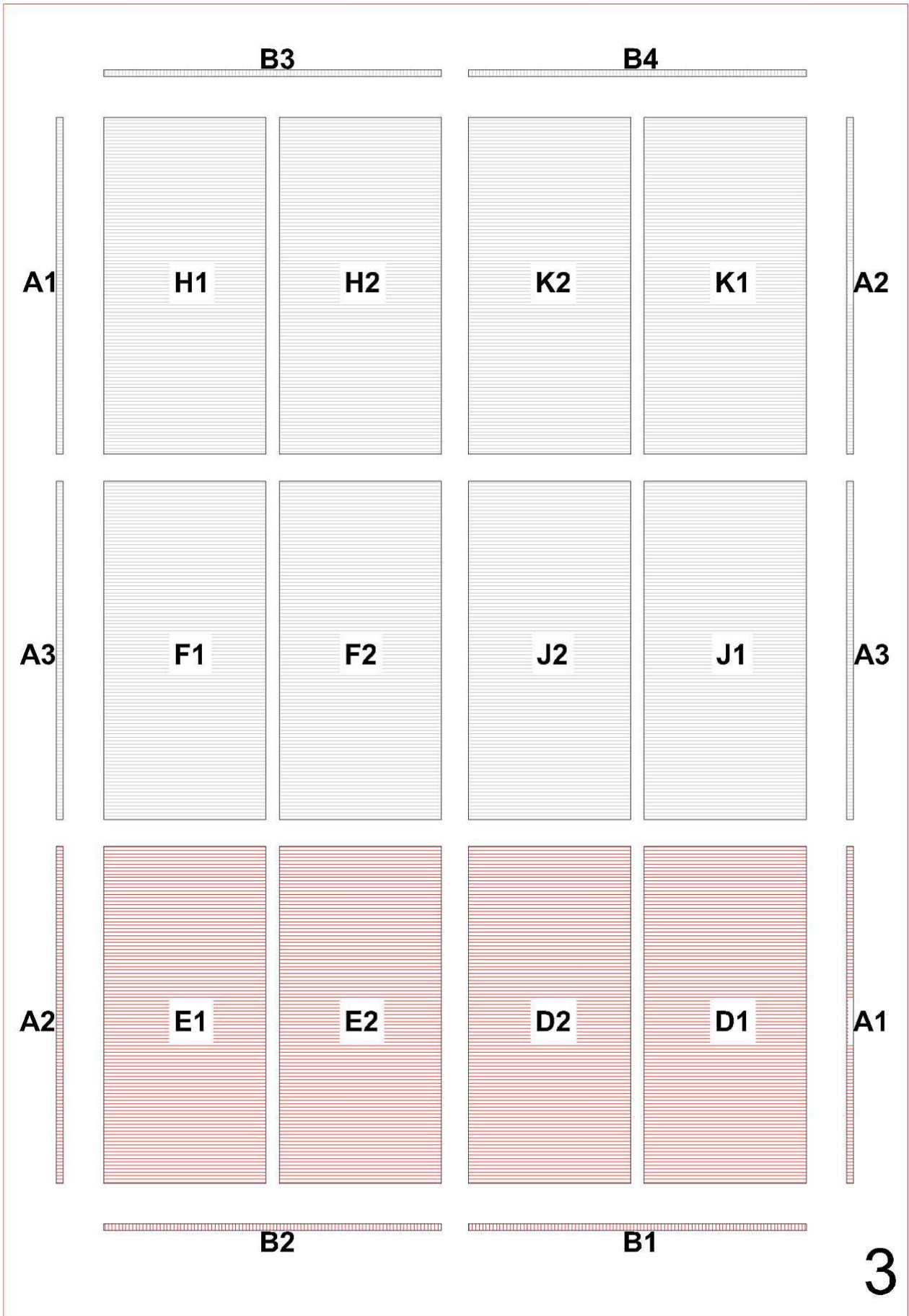

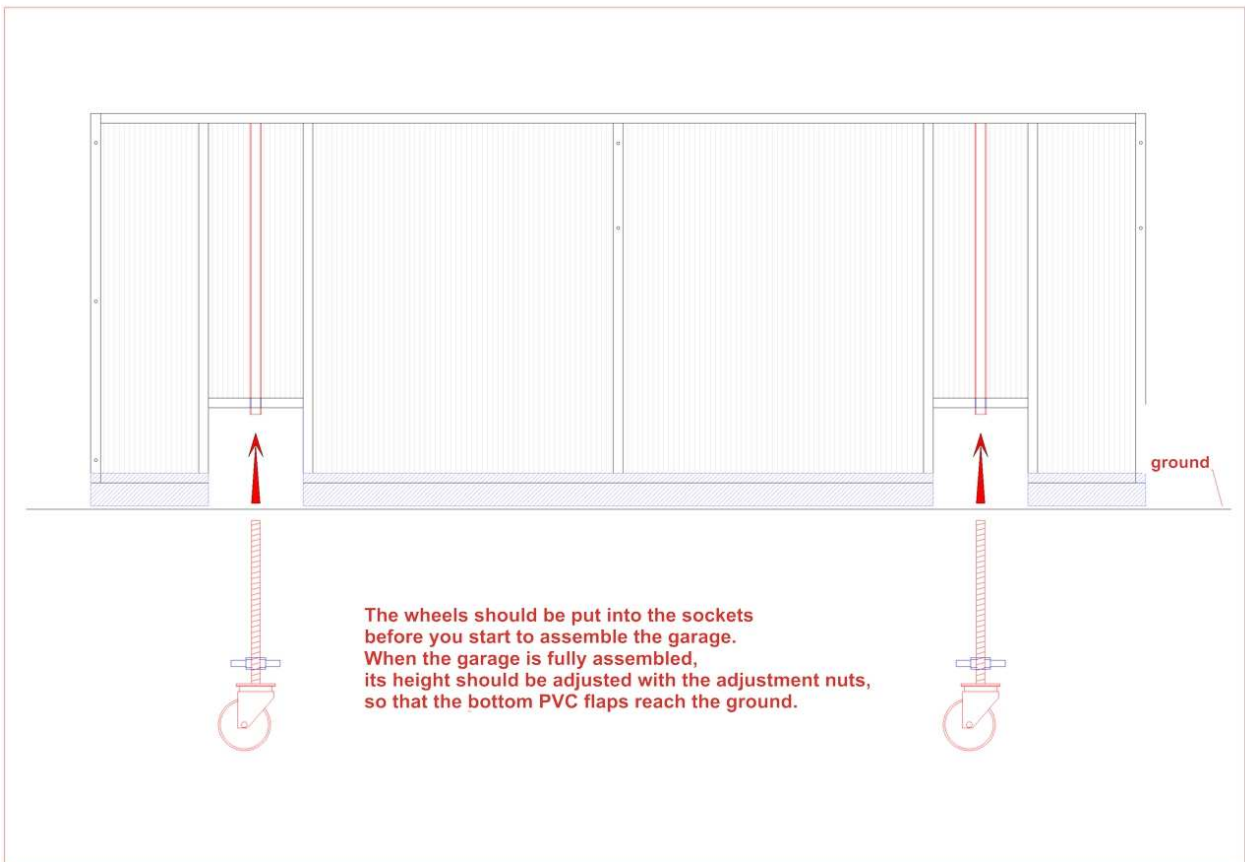
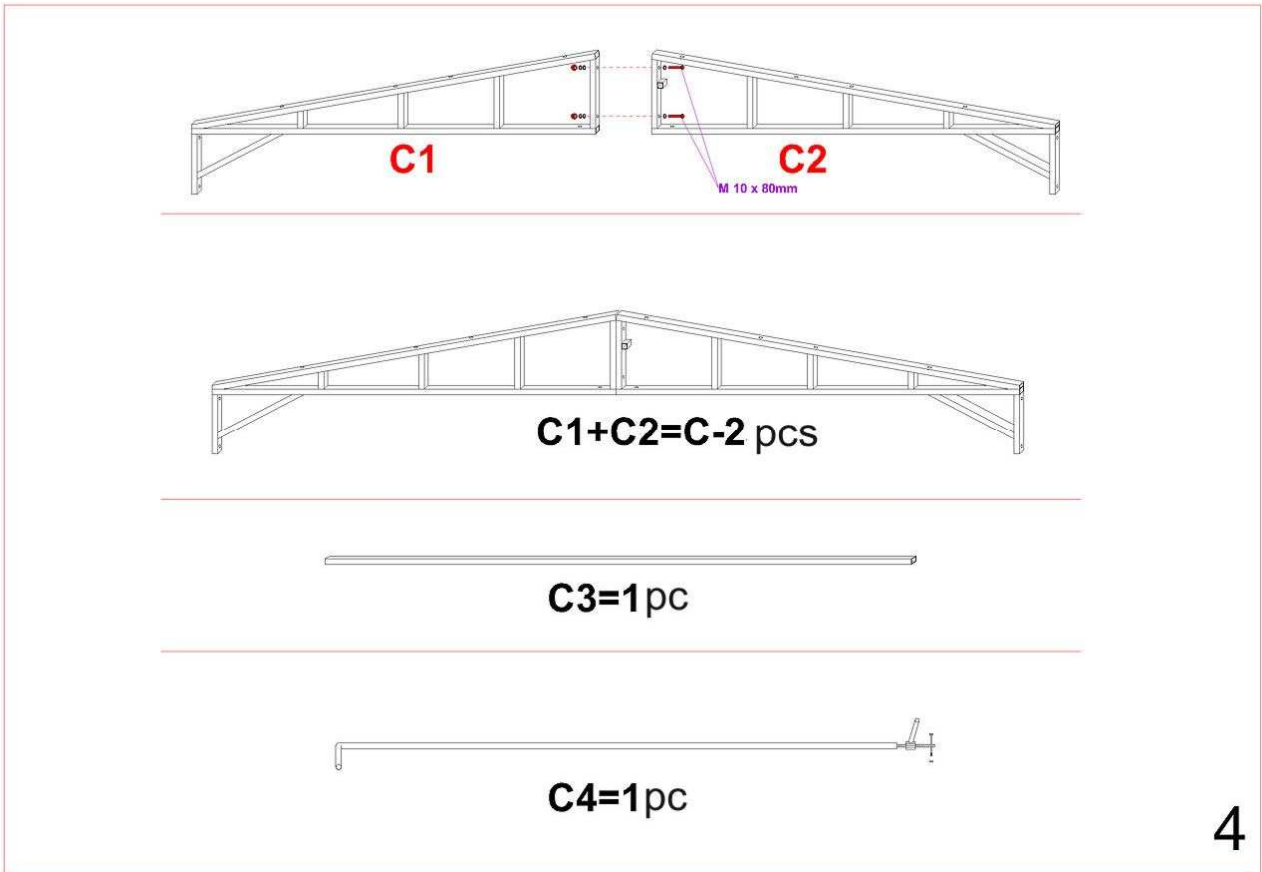

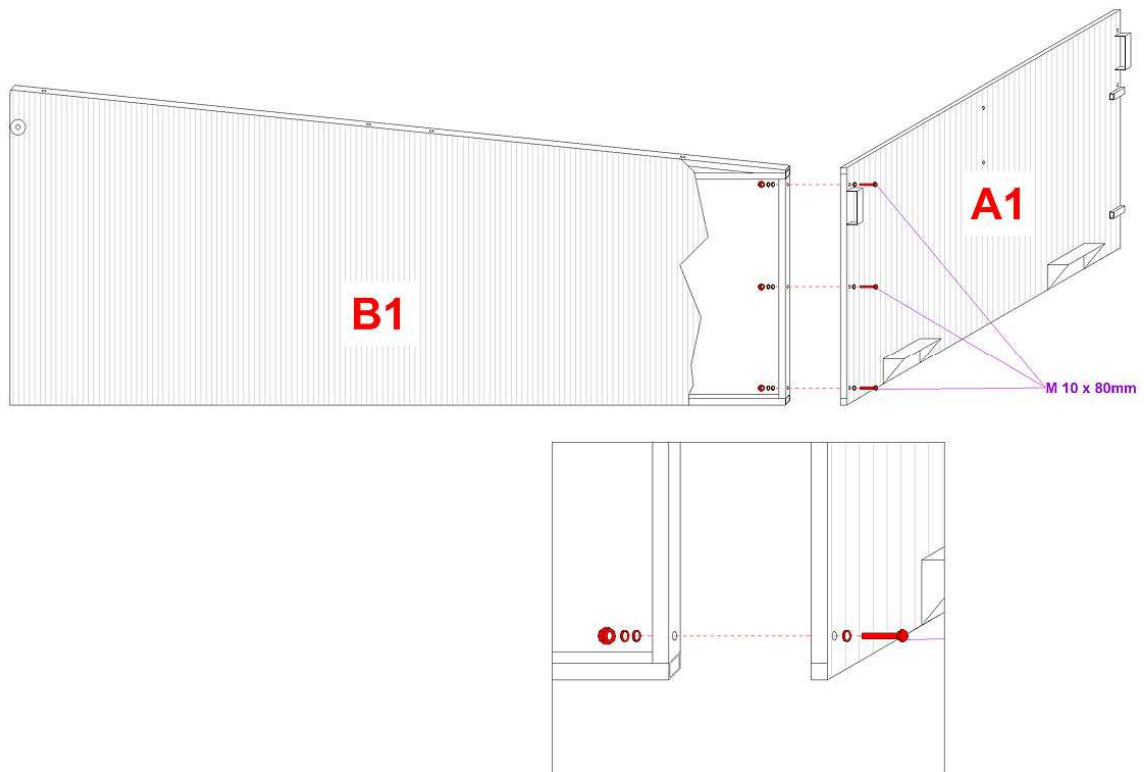

5

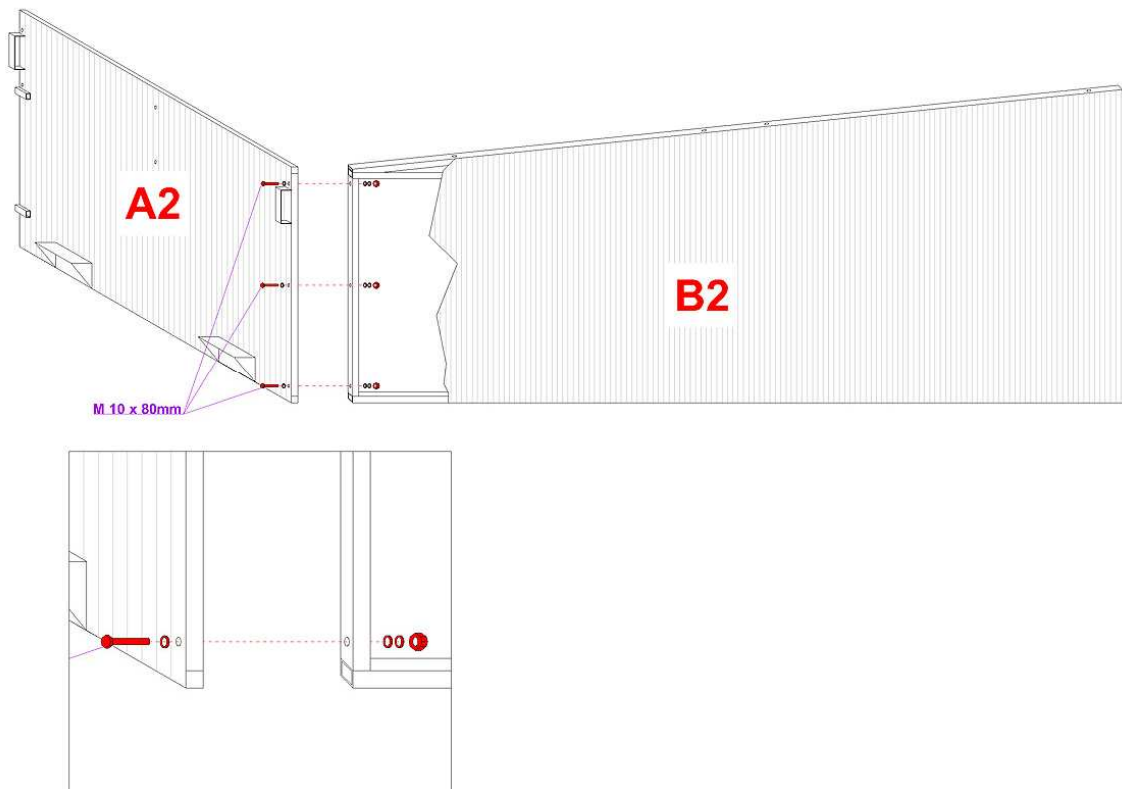

6

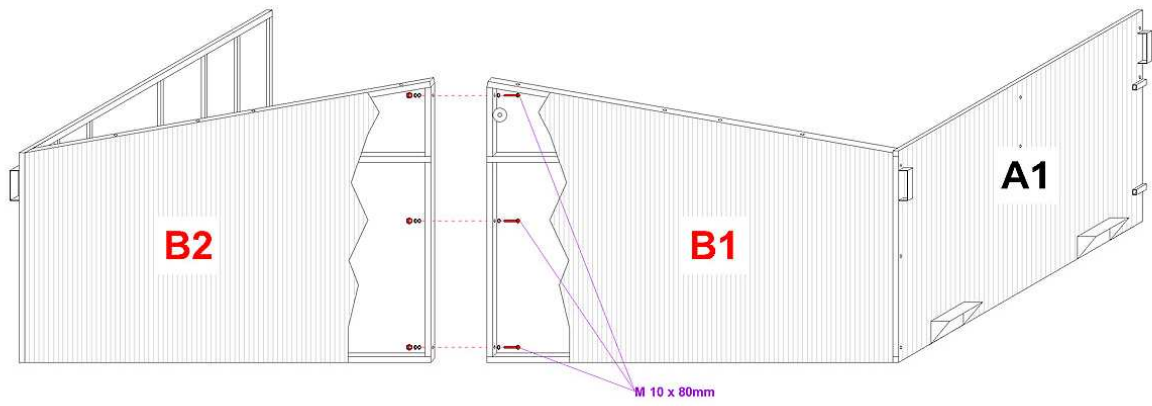

7

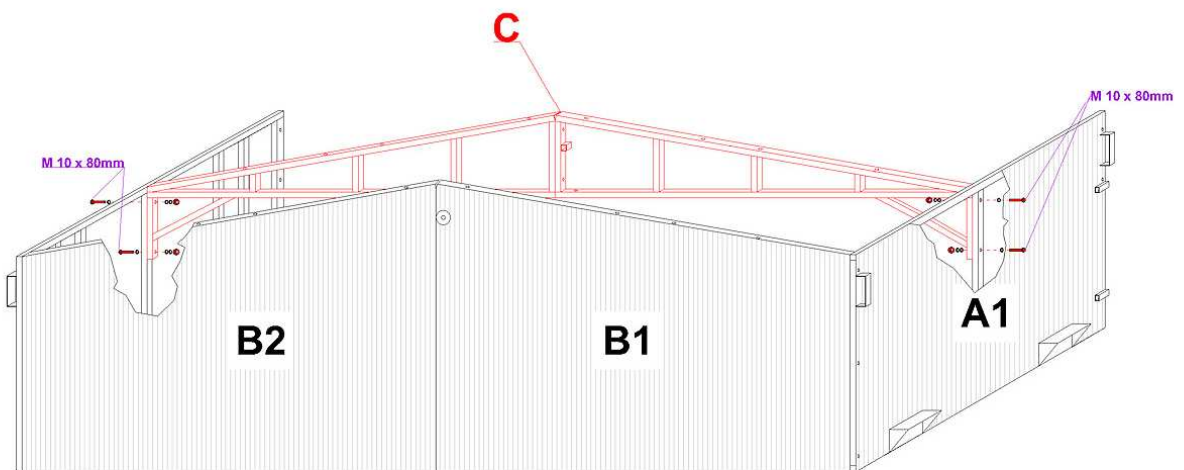
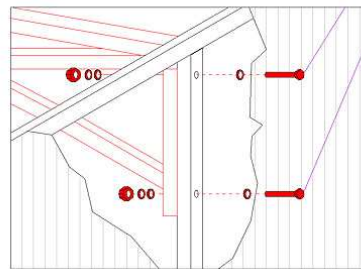
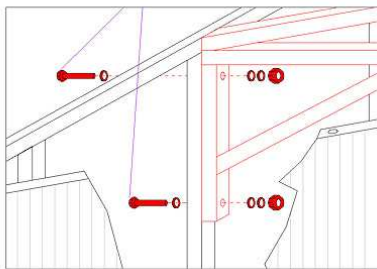

8

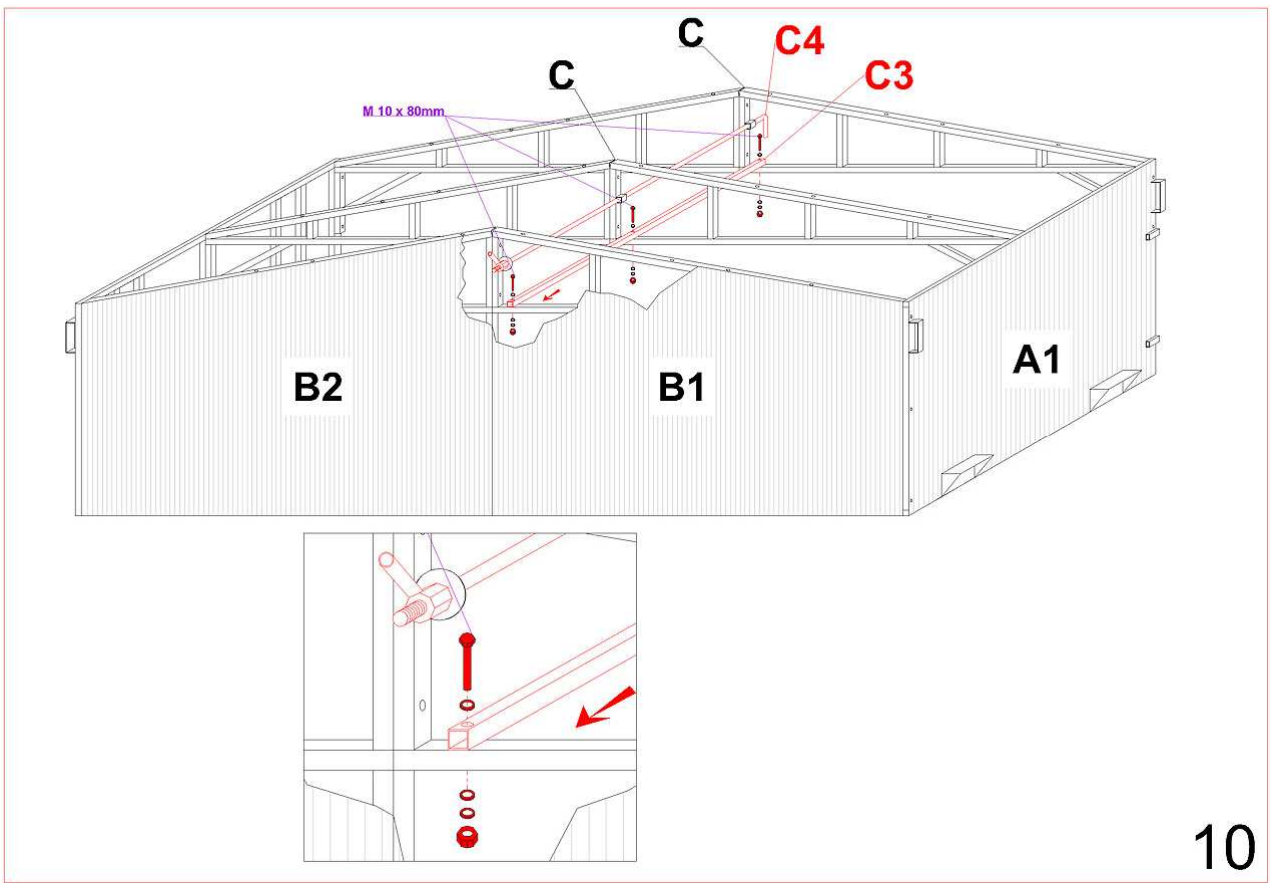
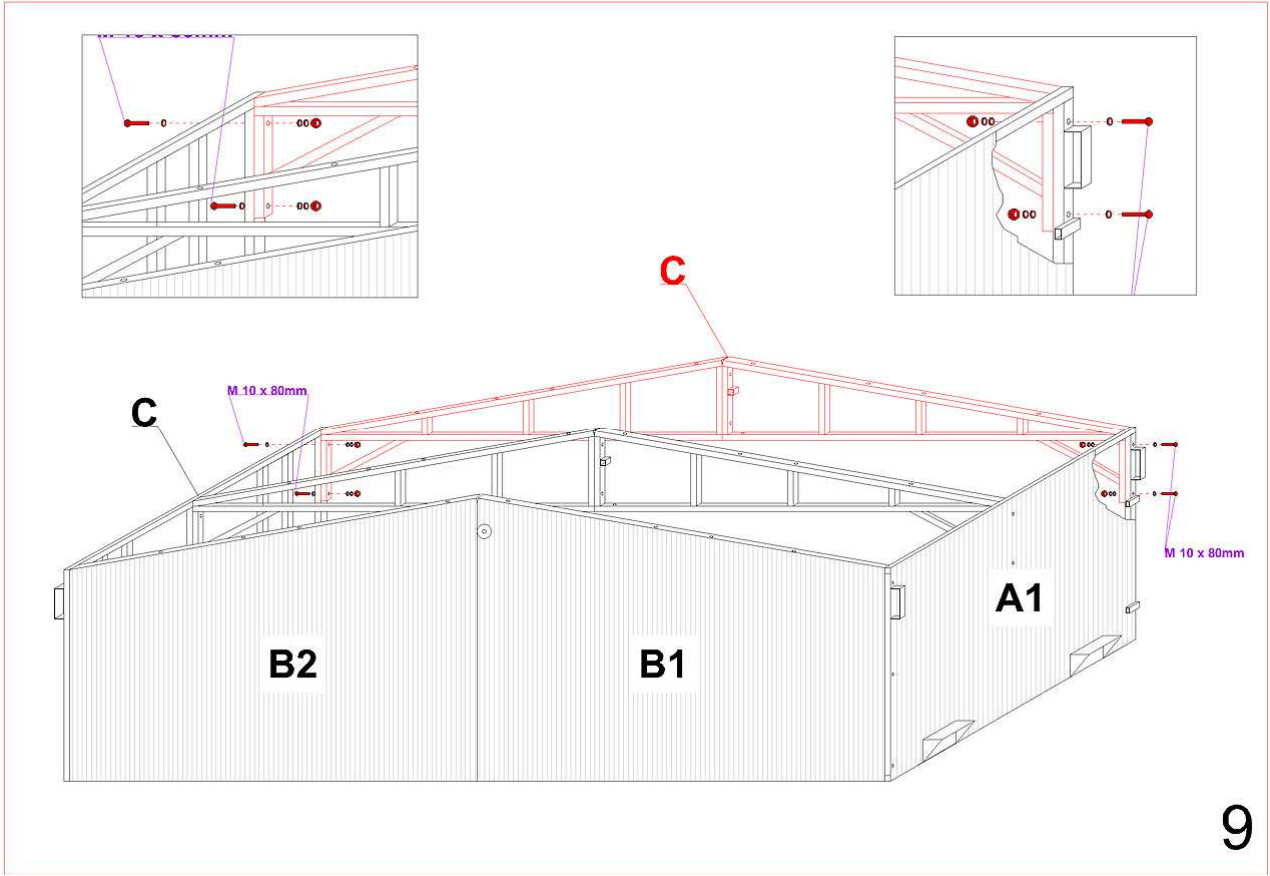

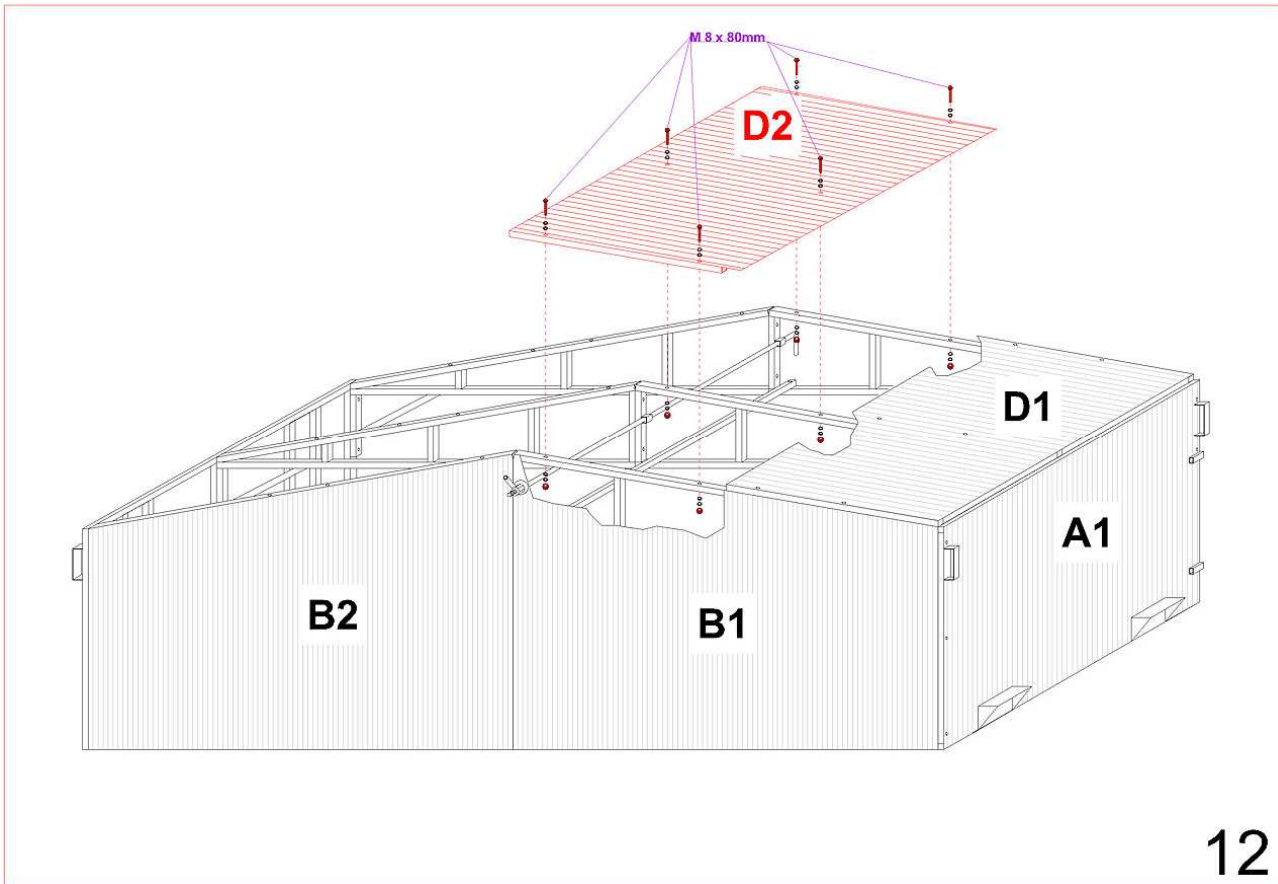
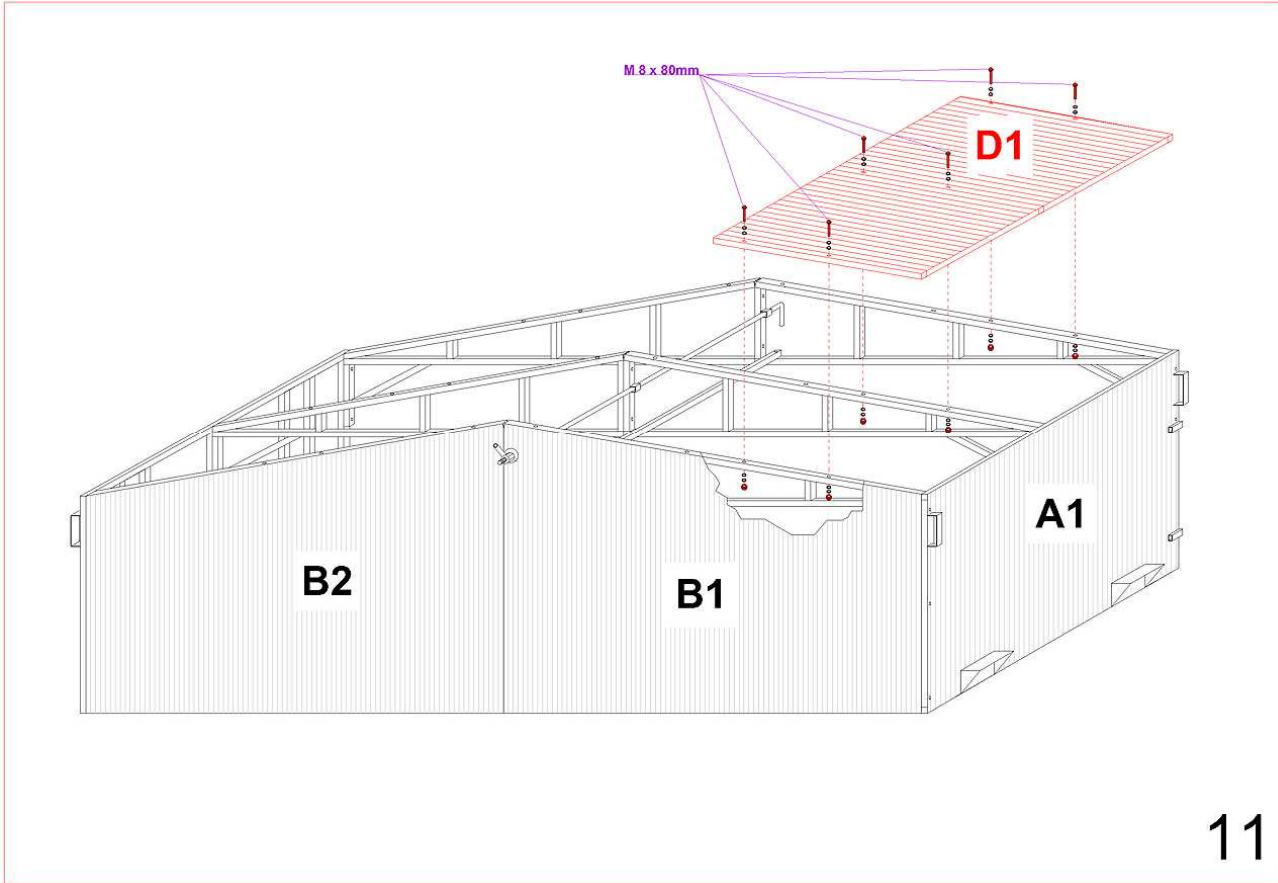

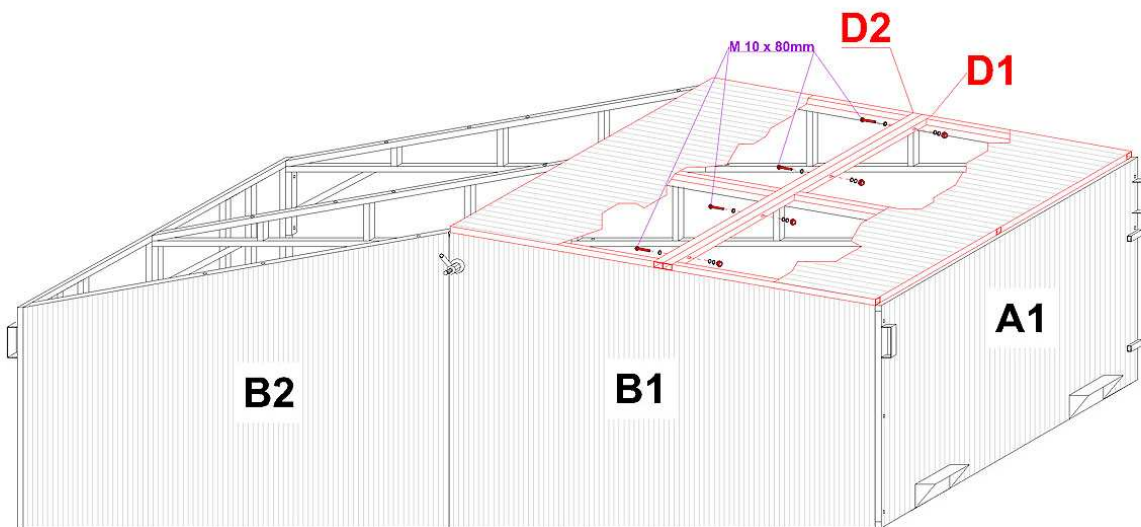

13

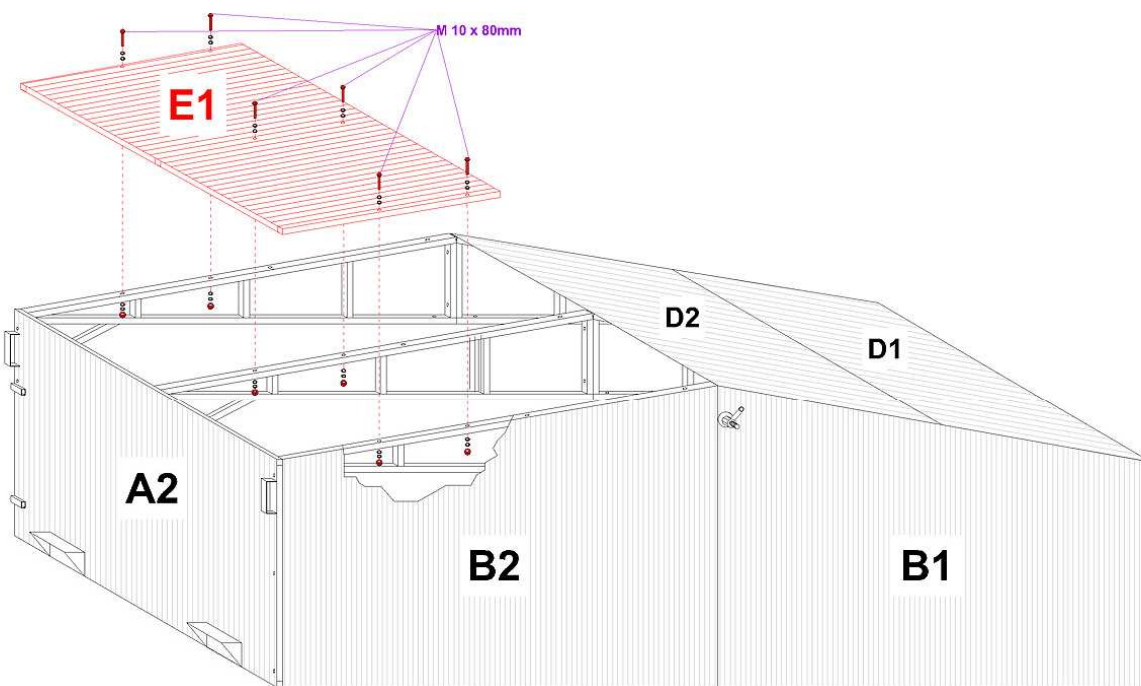

14

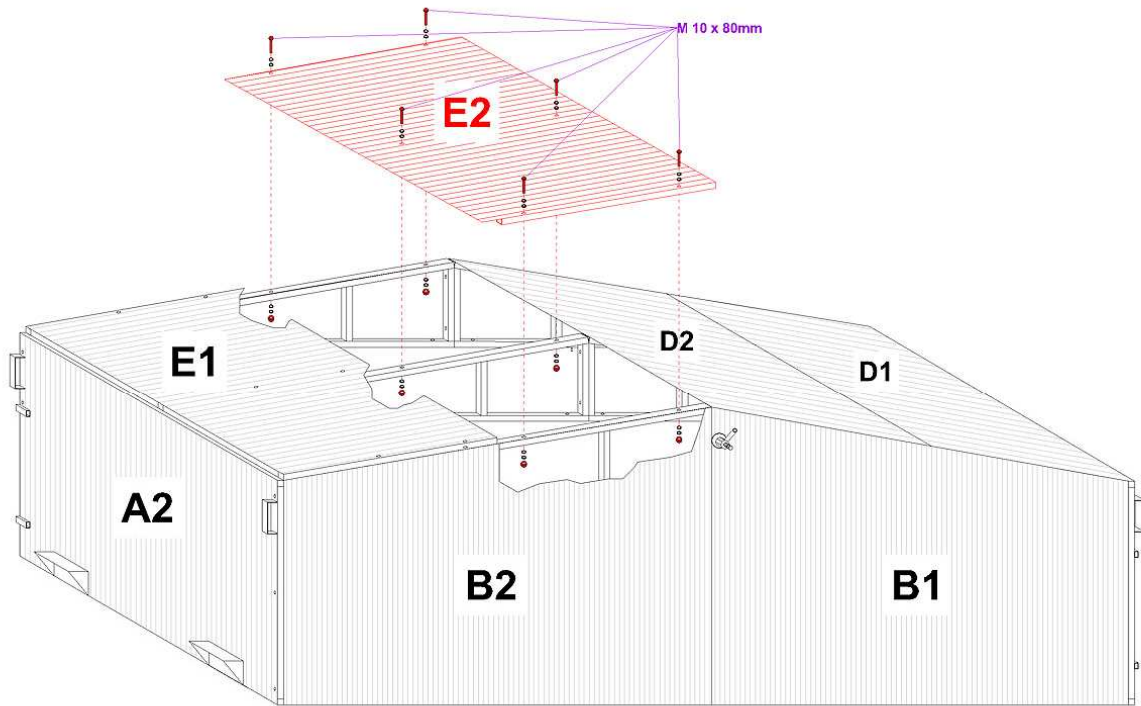

15

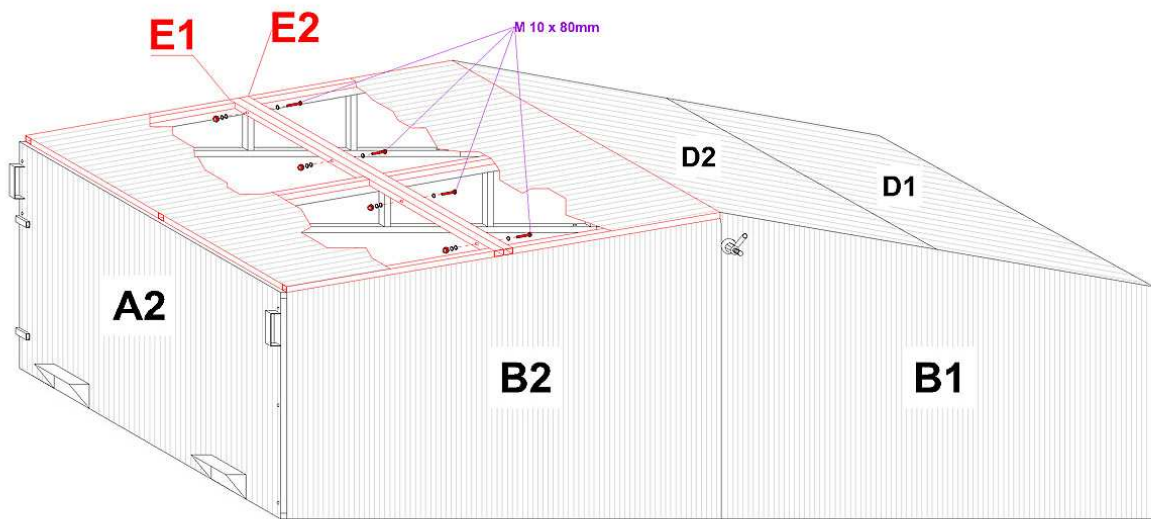

16

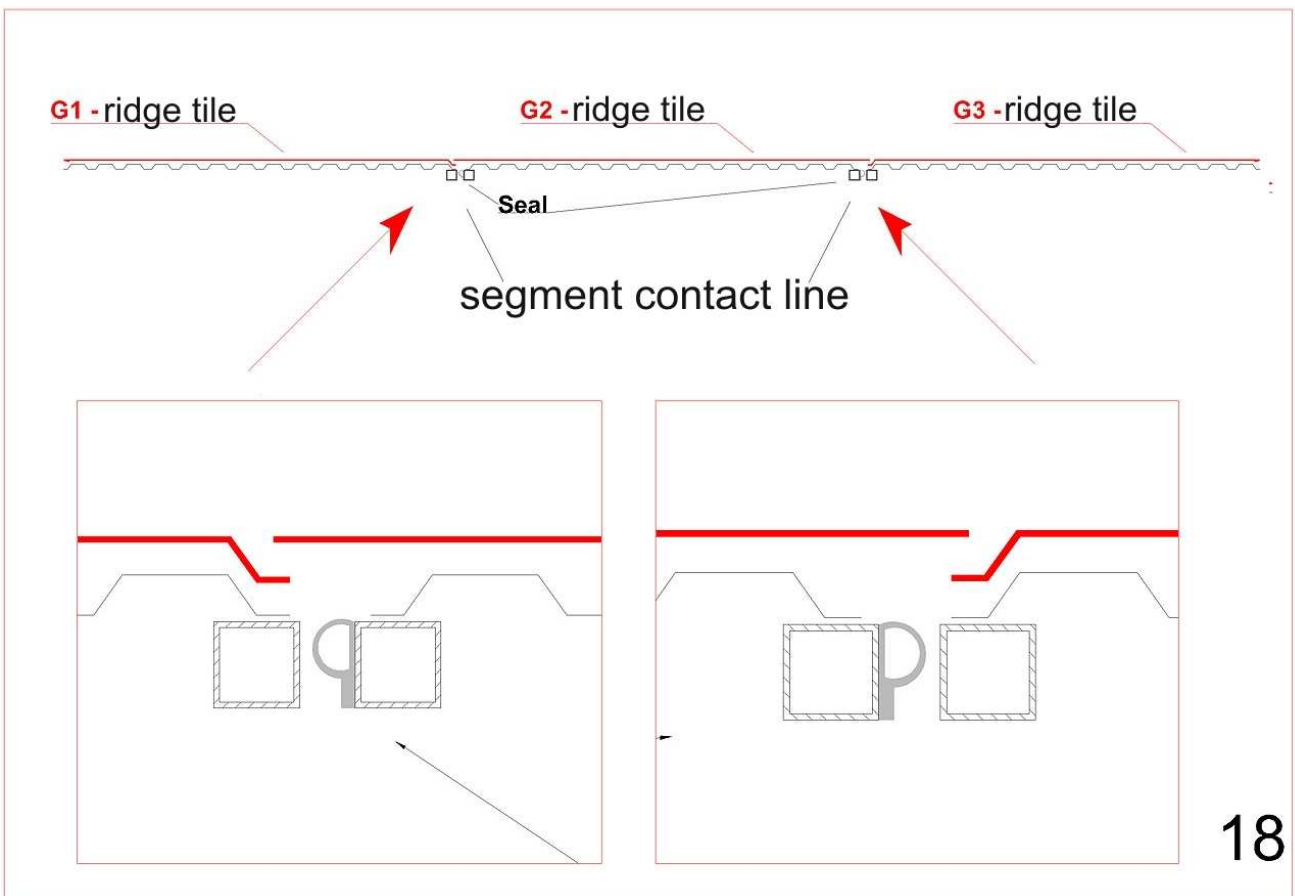
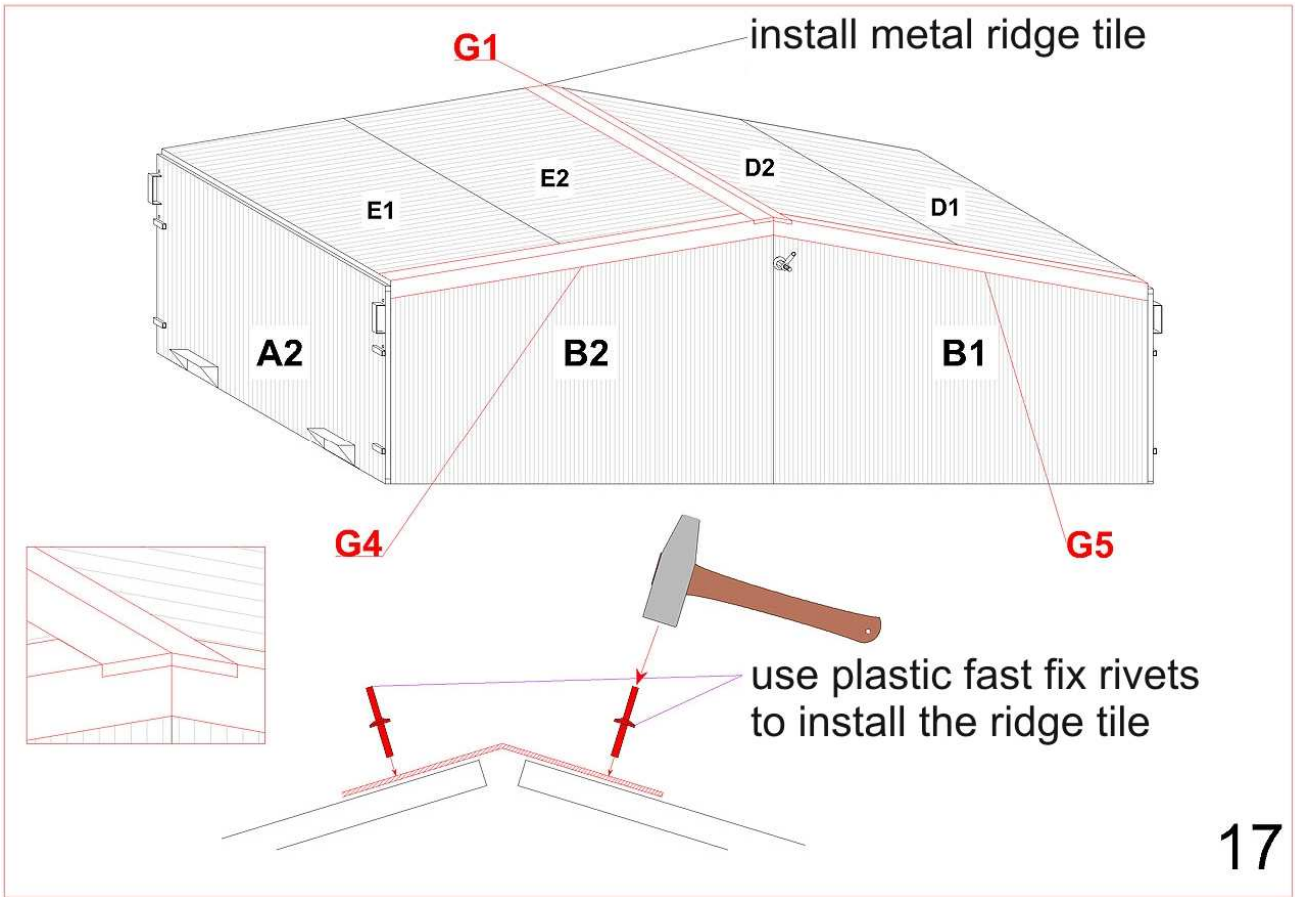

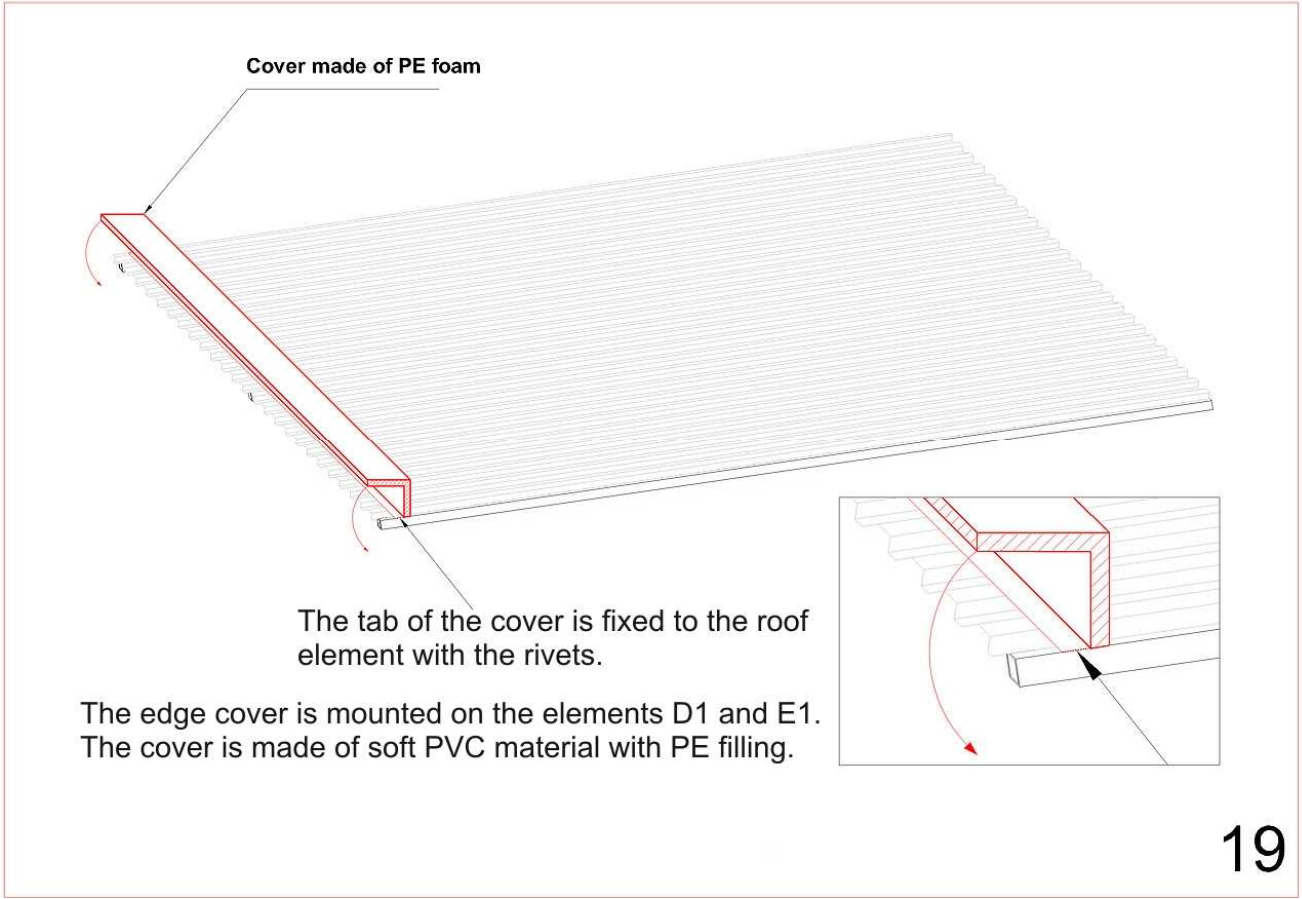

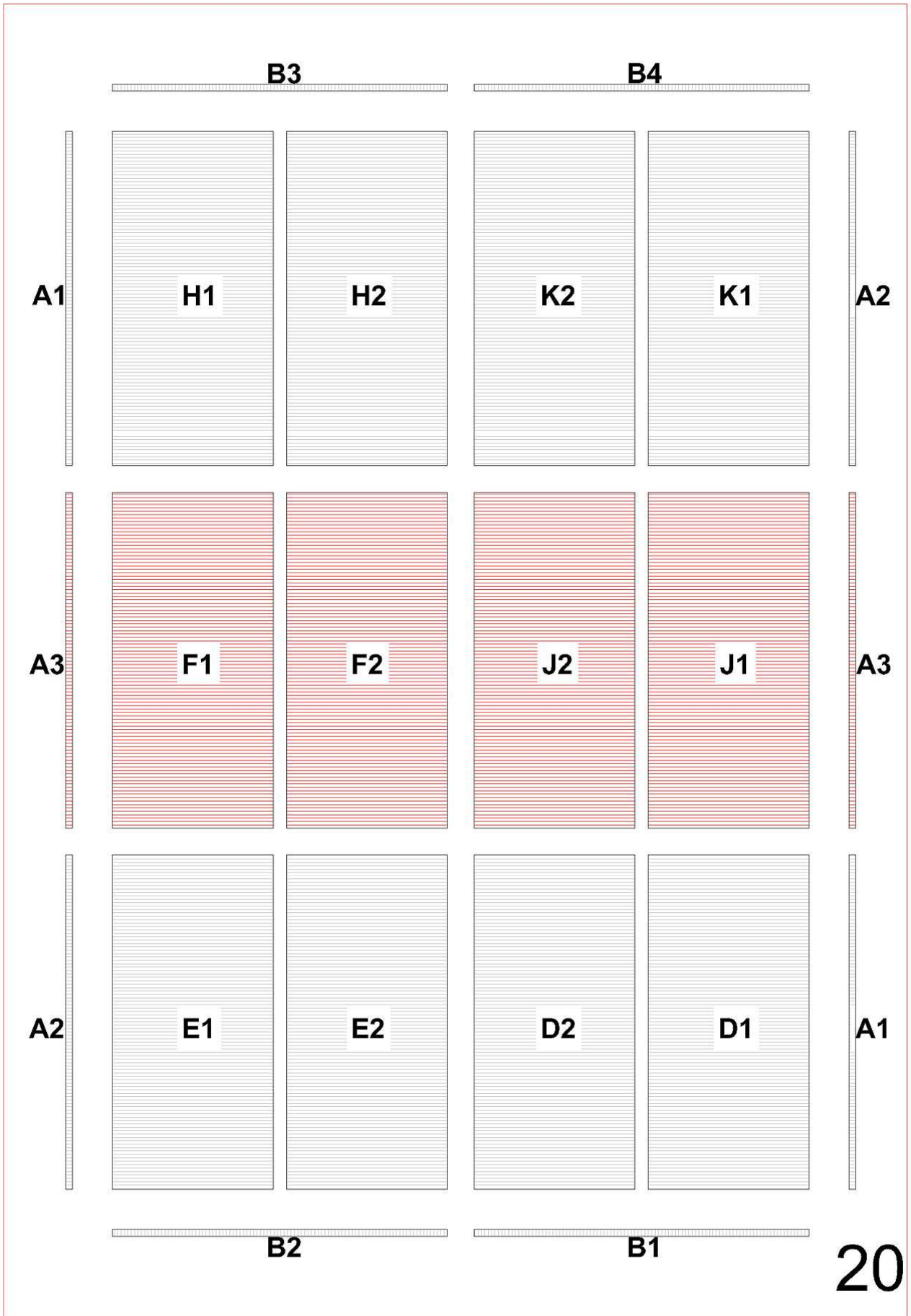

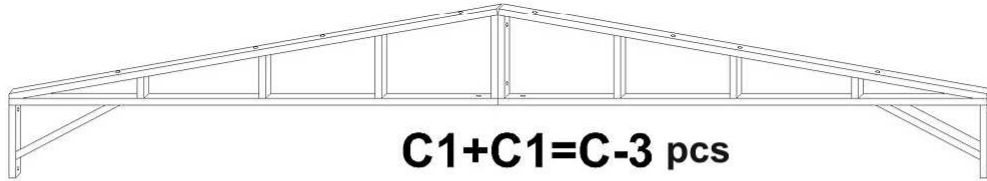
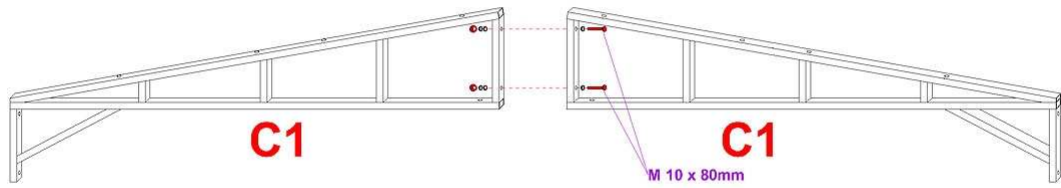

21

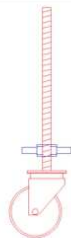
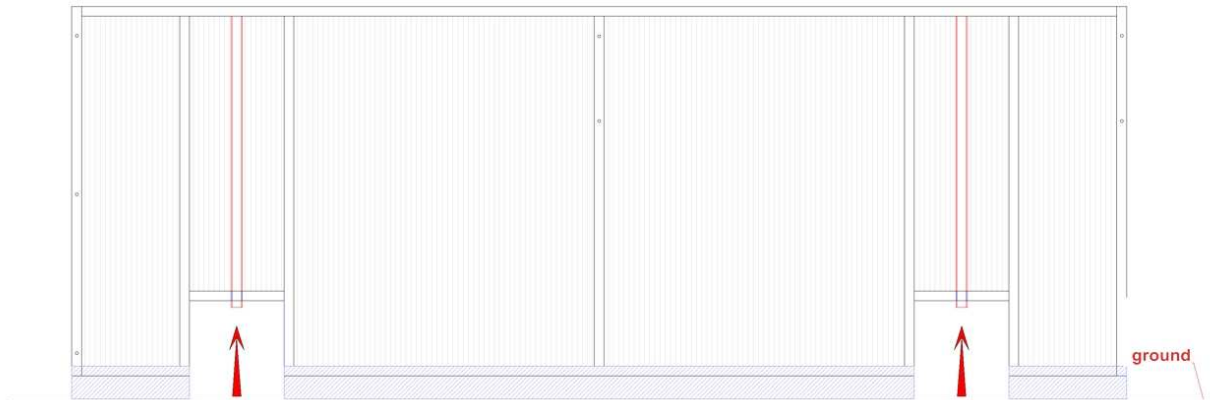

The wheels should be put into the sockets before you start to assemble the garage. When the garage is fully assembled, its height should be adjusted with the adjustment nuts, so that the bottom PVC flaps reach the ground.

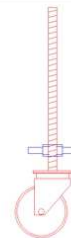

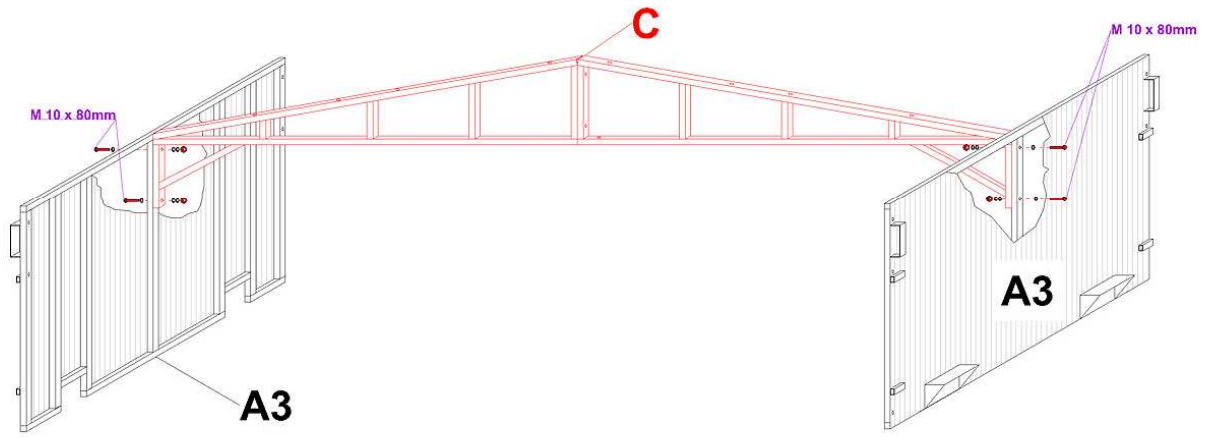

22

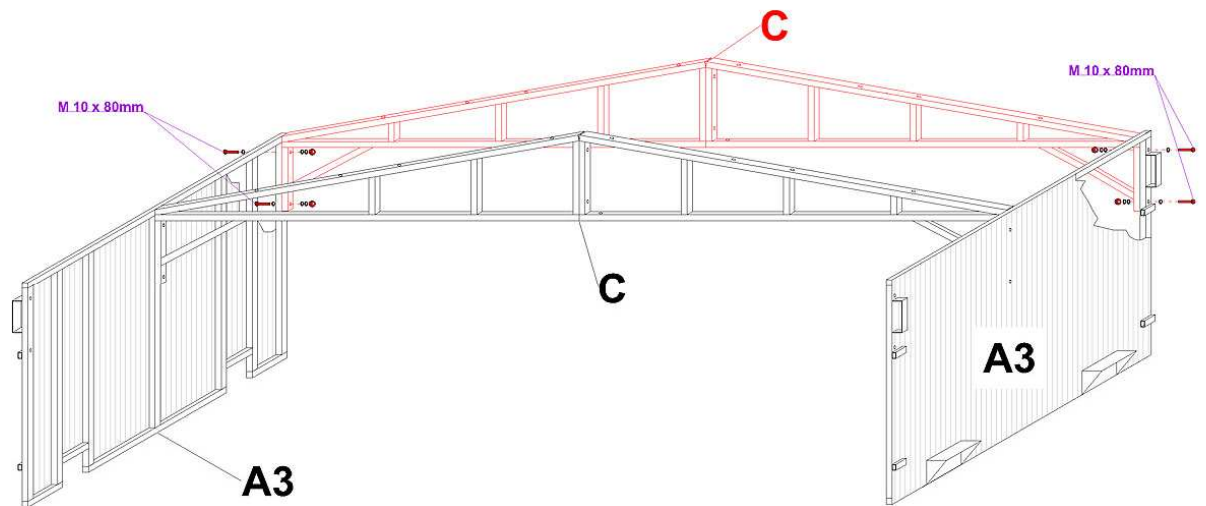

23

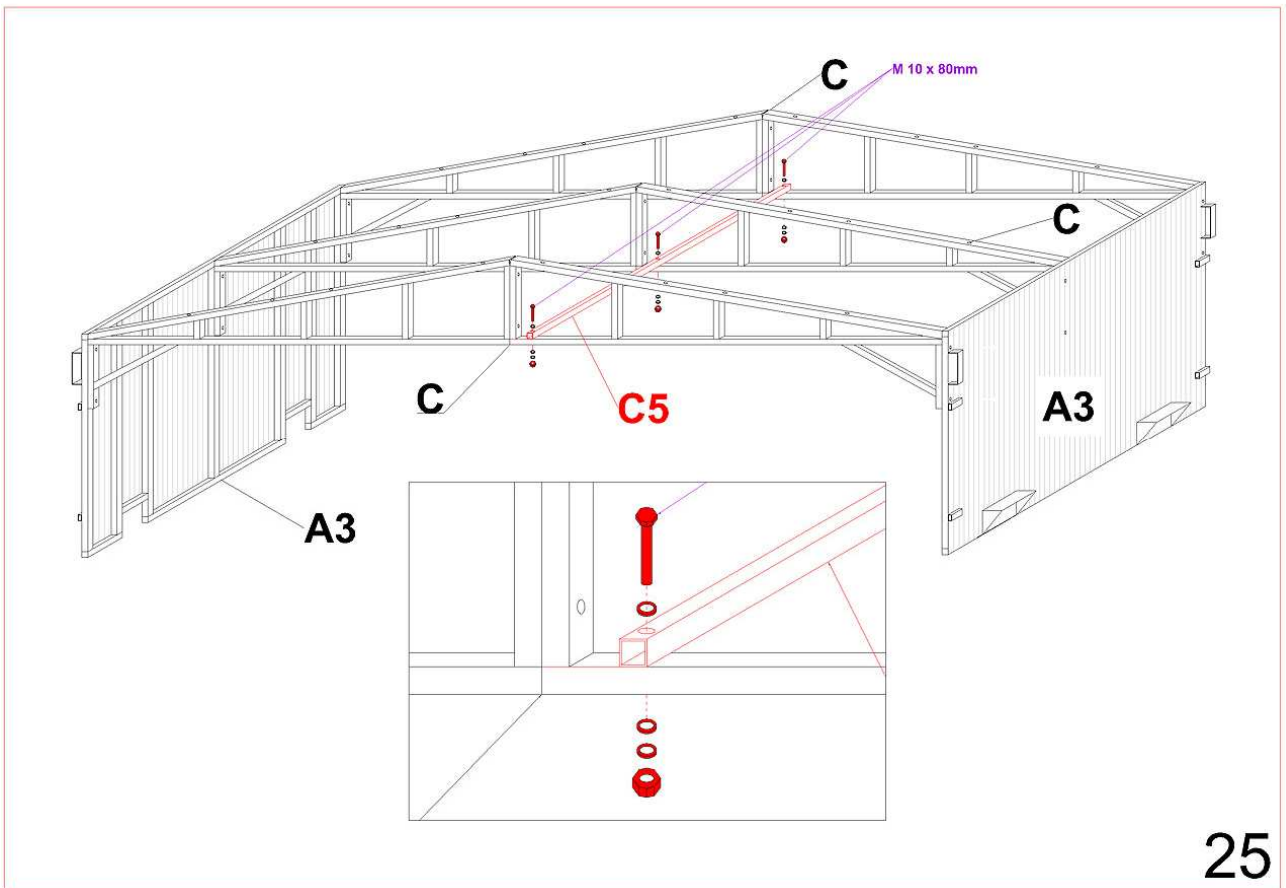
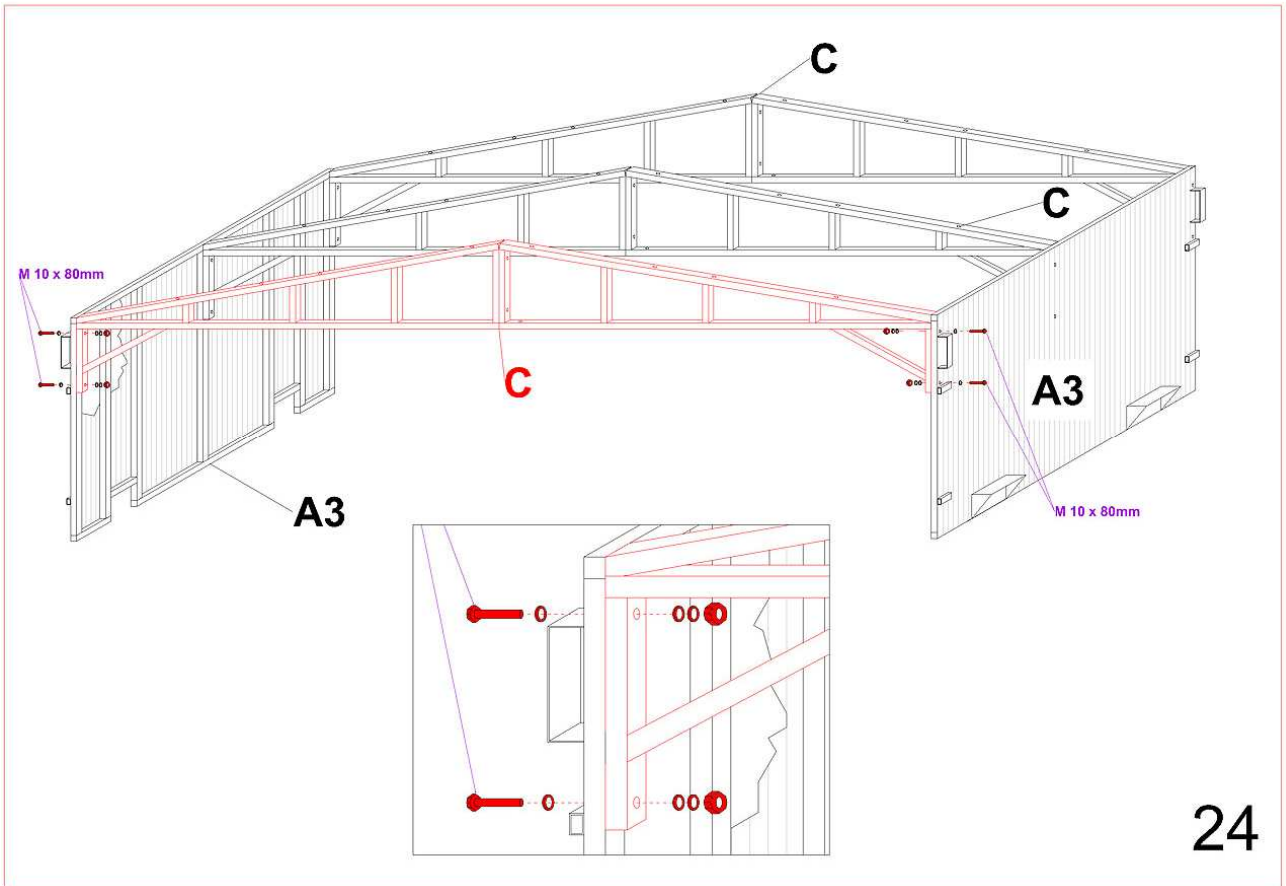

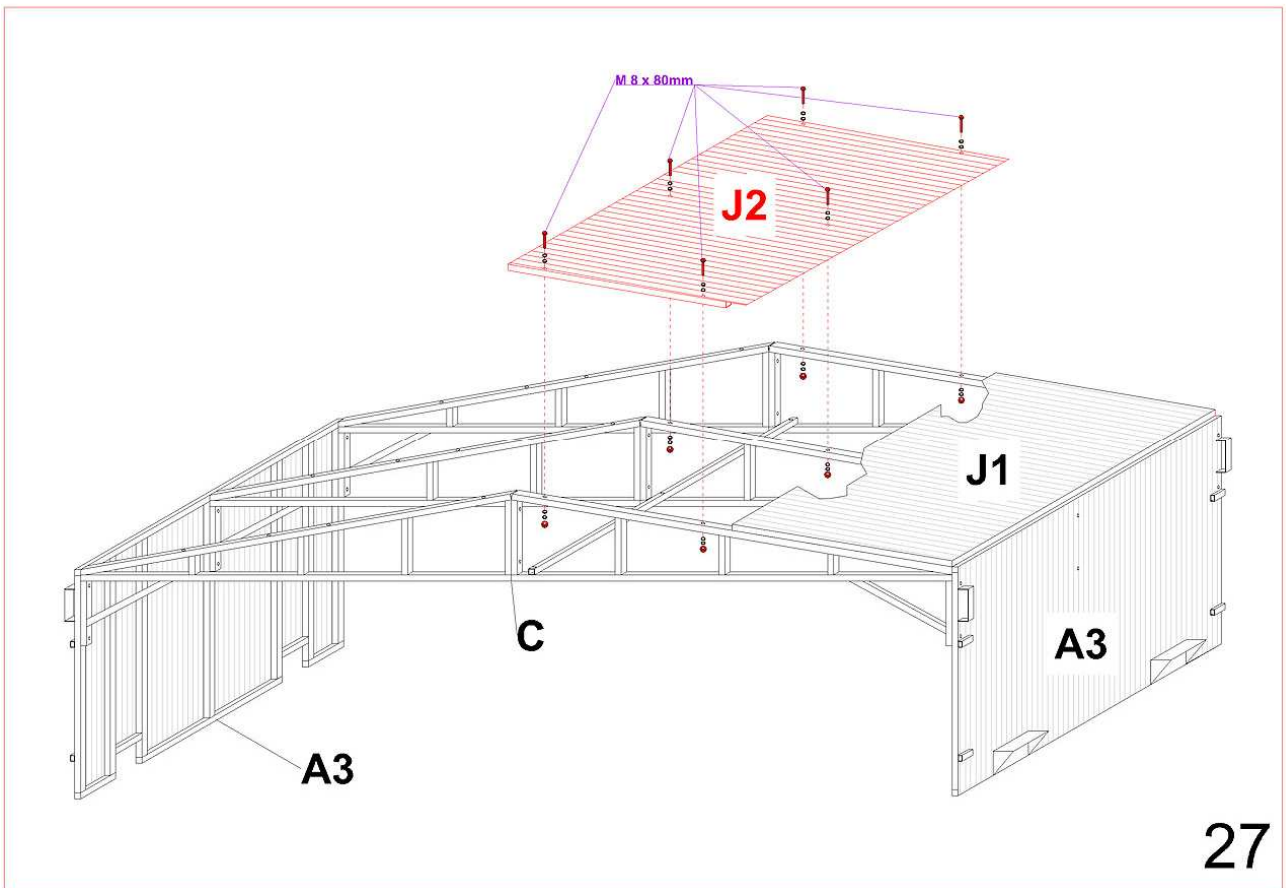
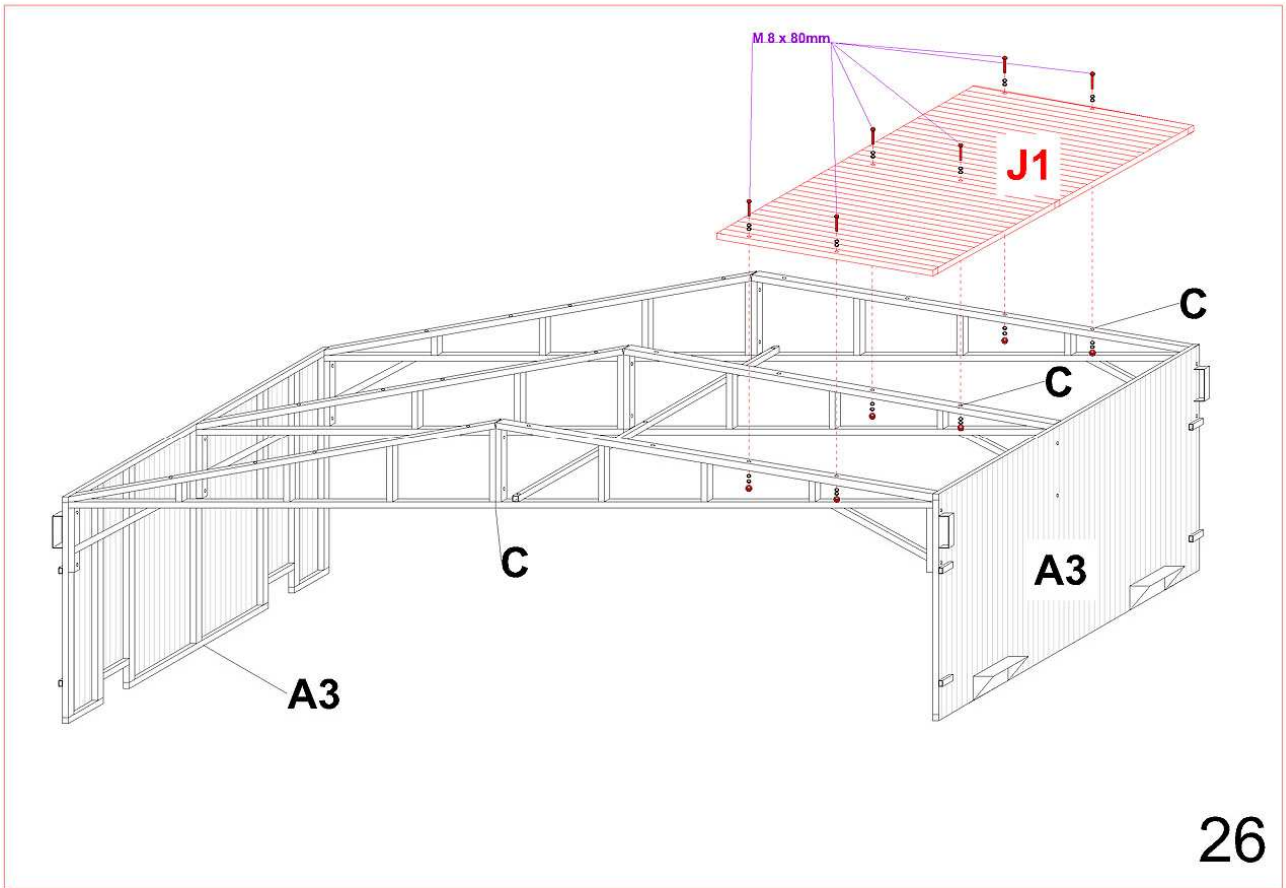

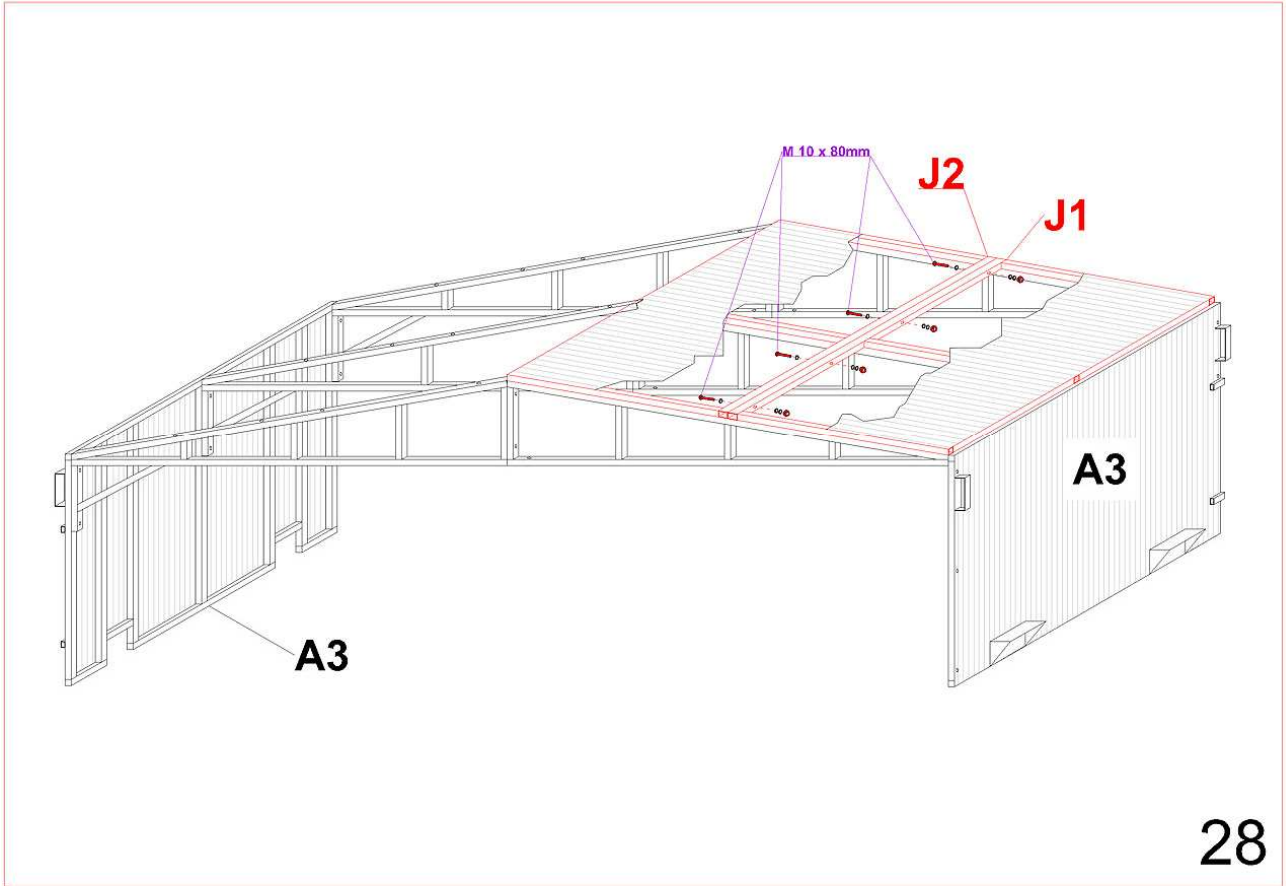

28

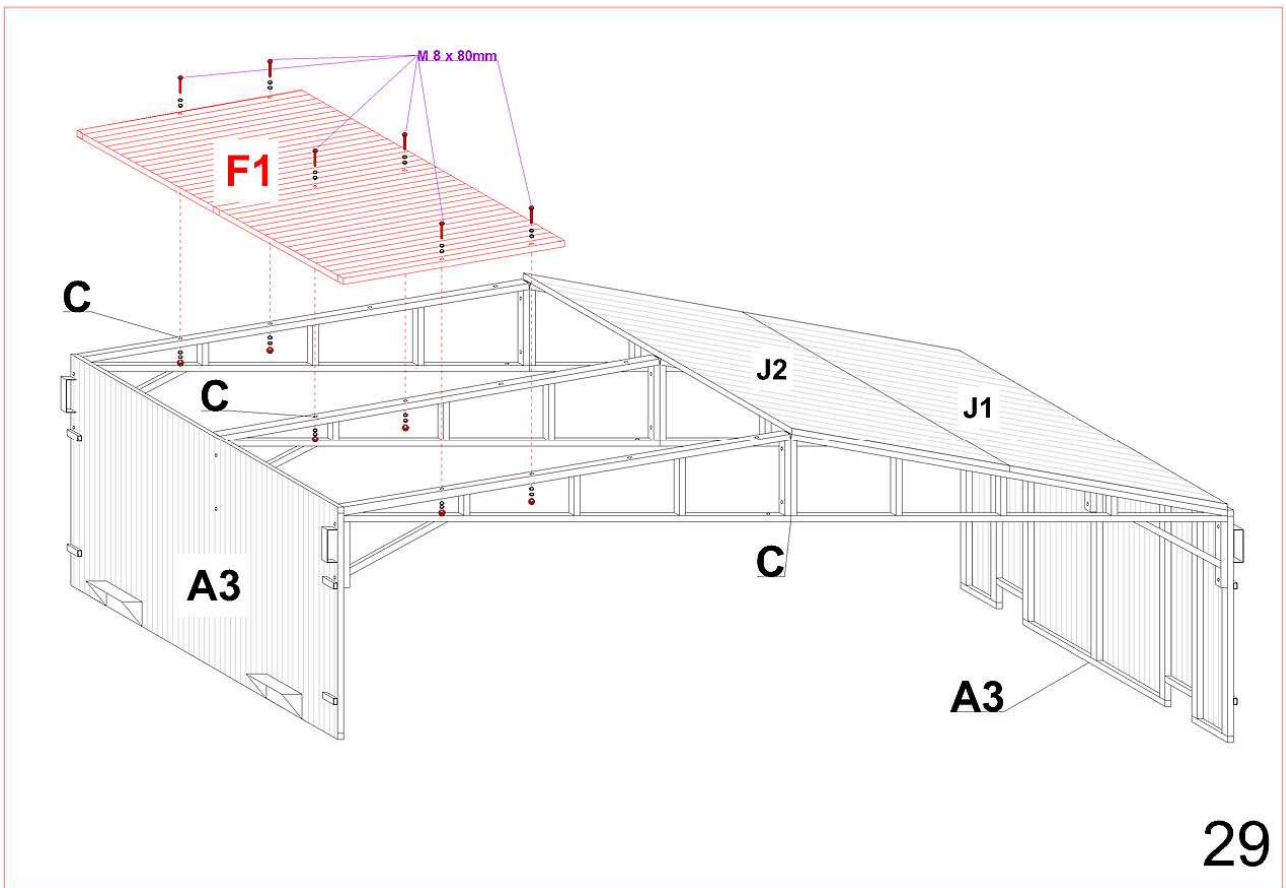

29

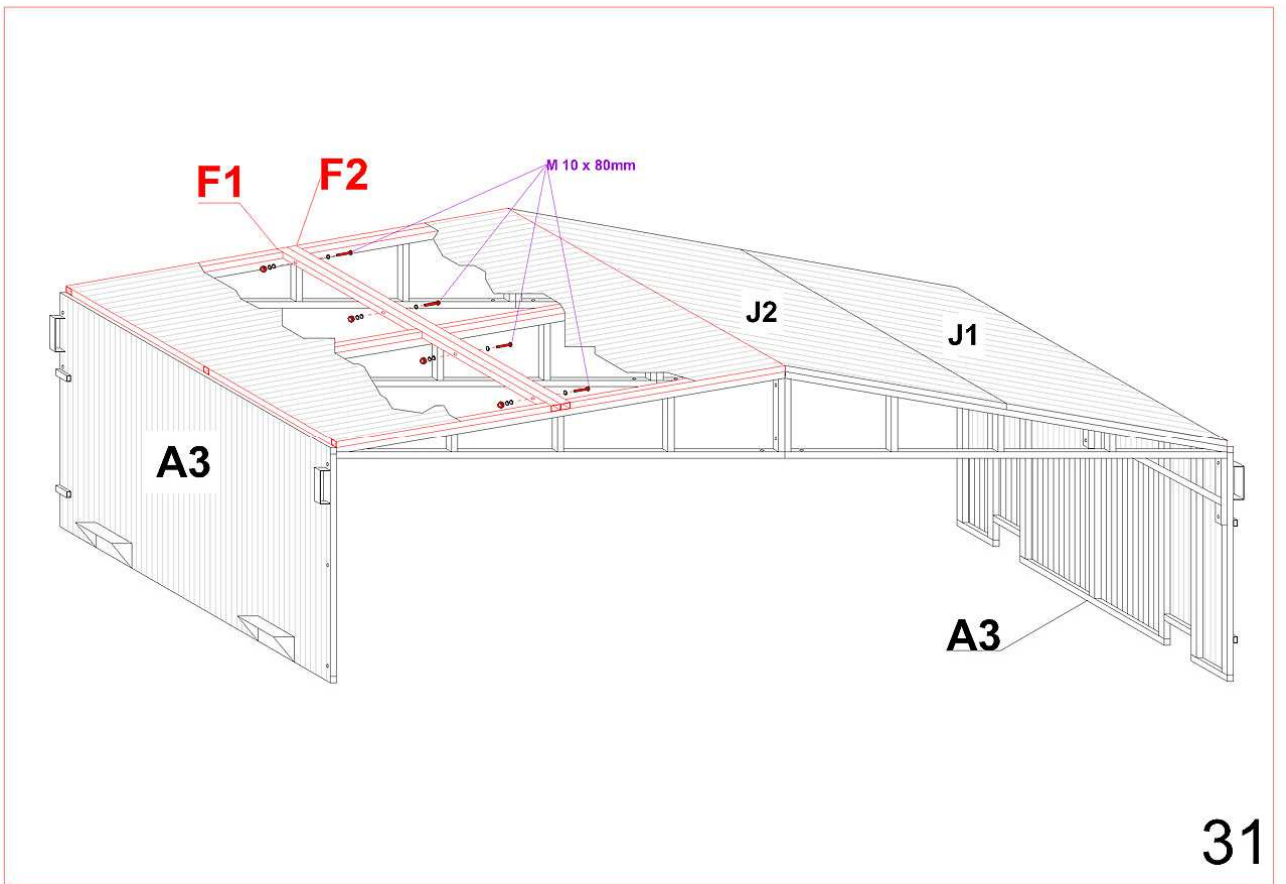
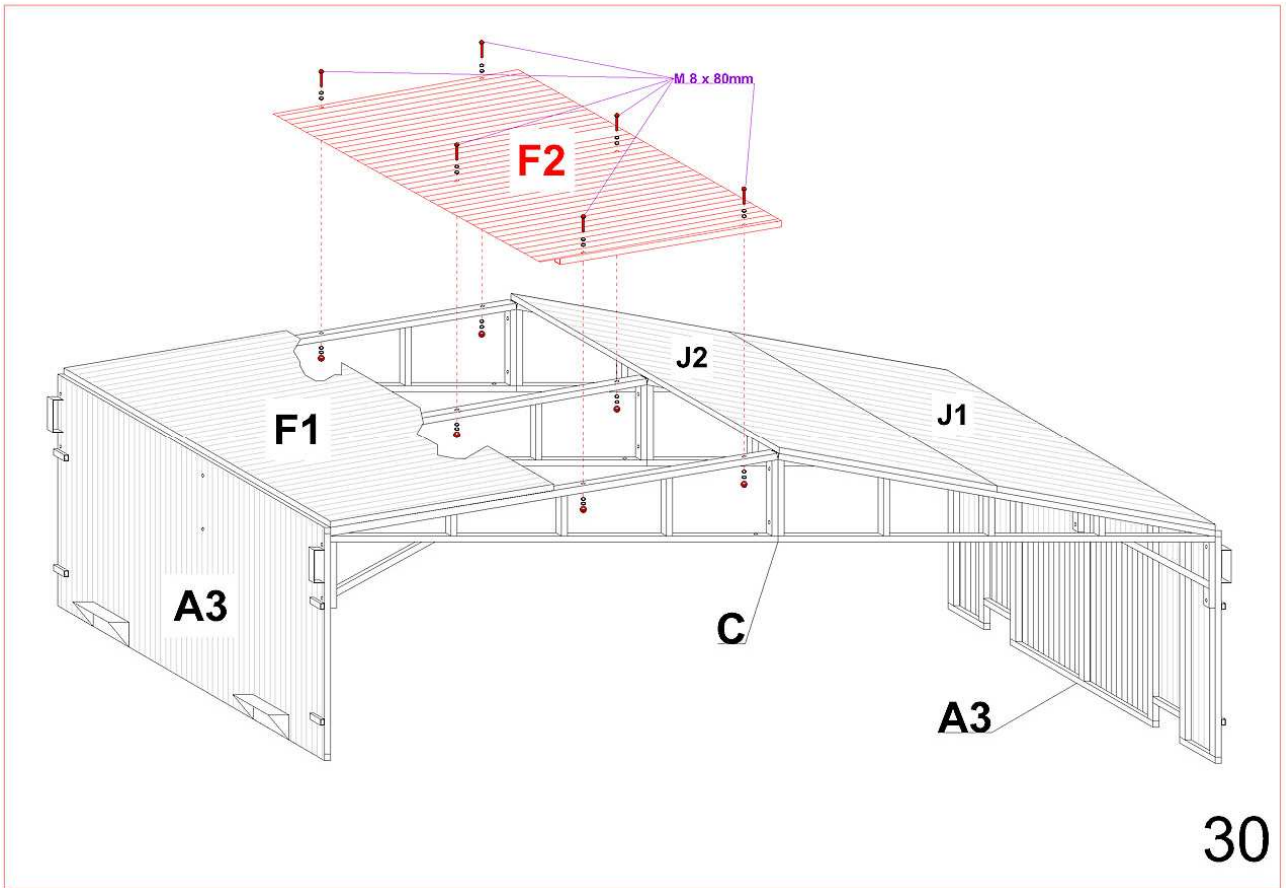

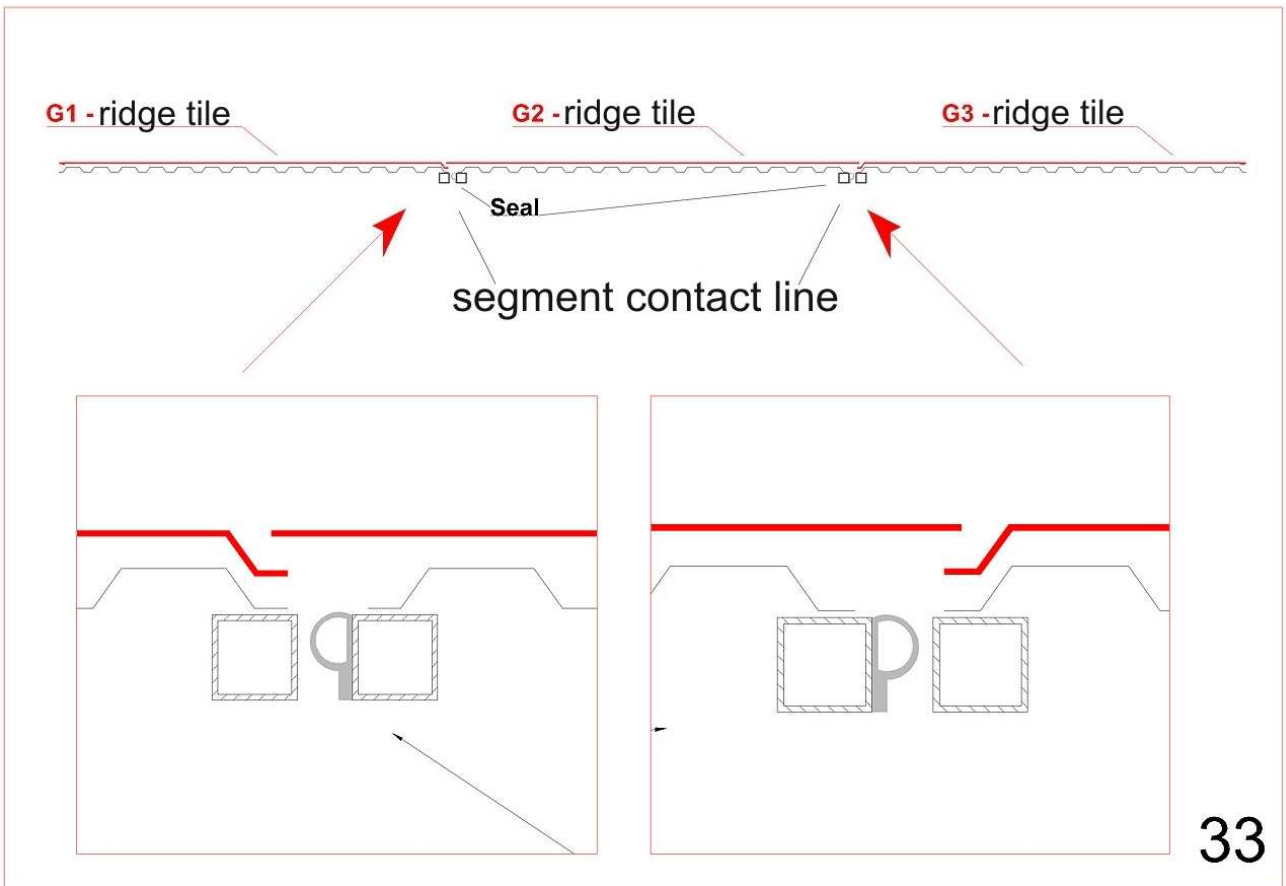
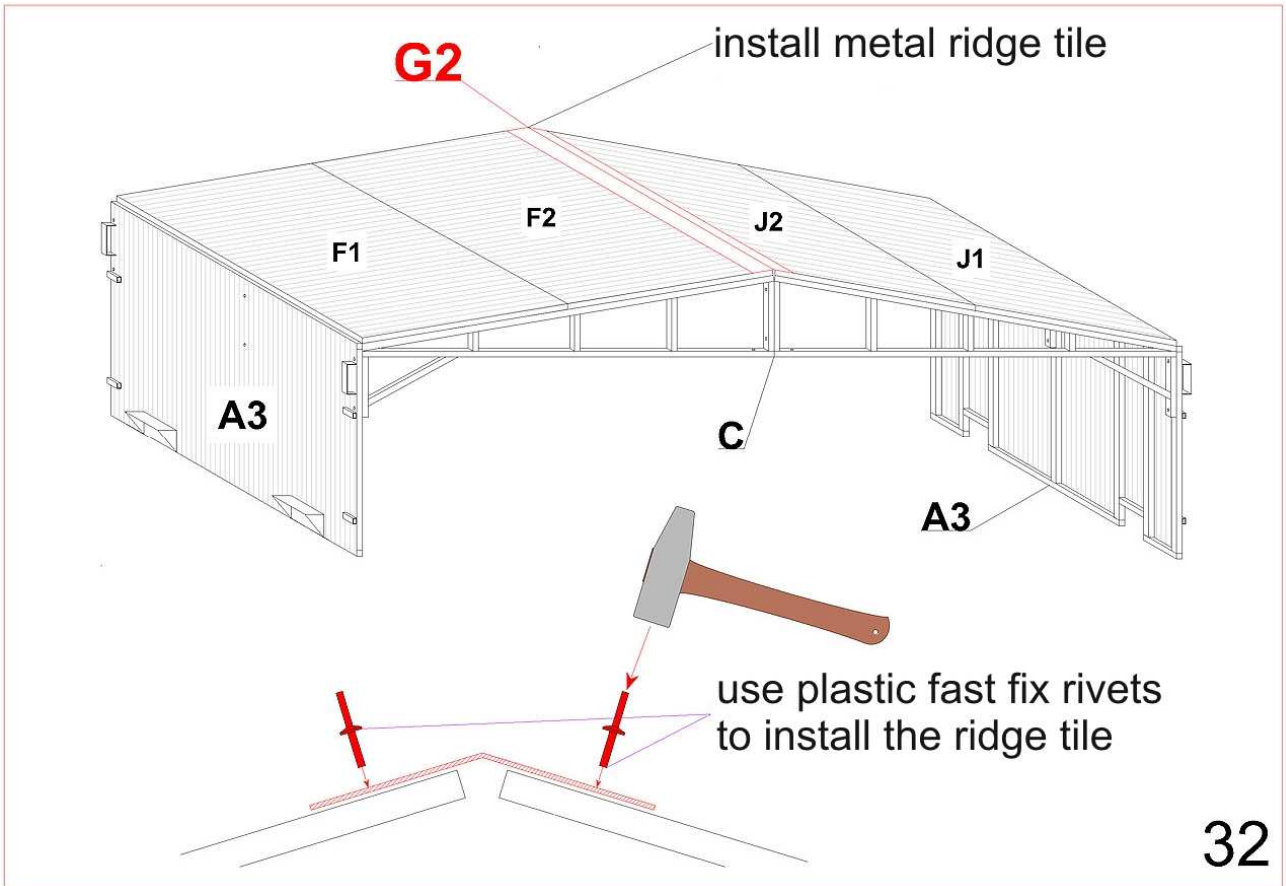

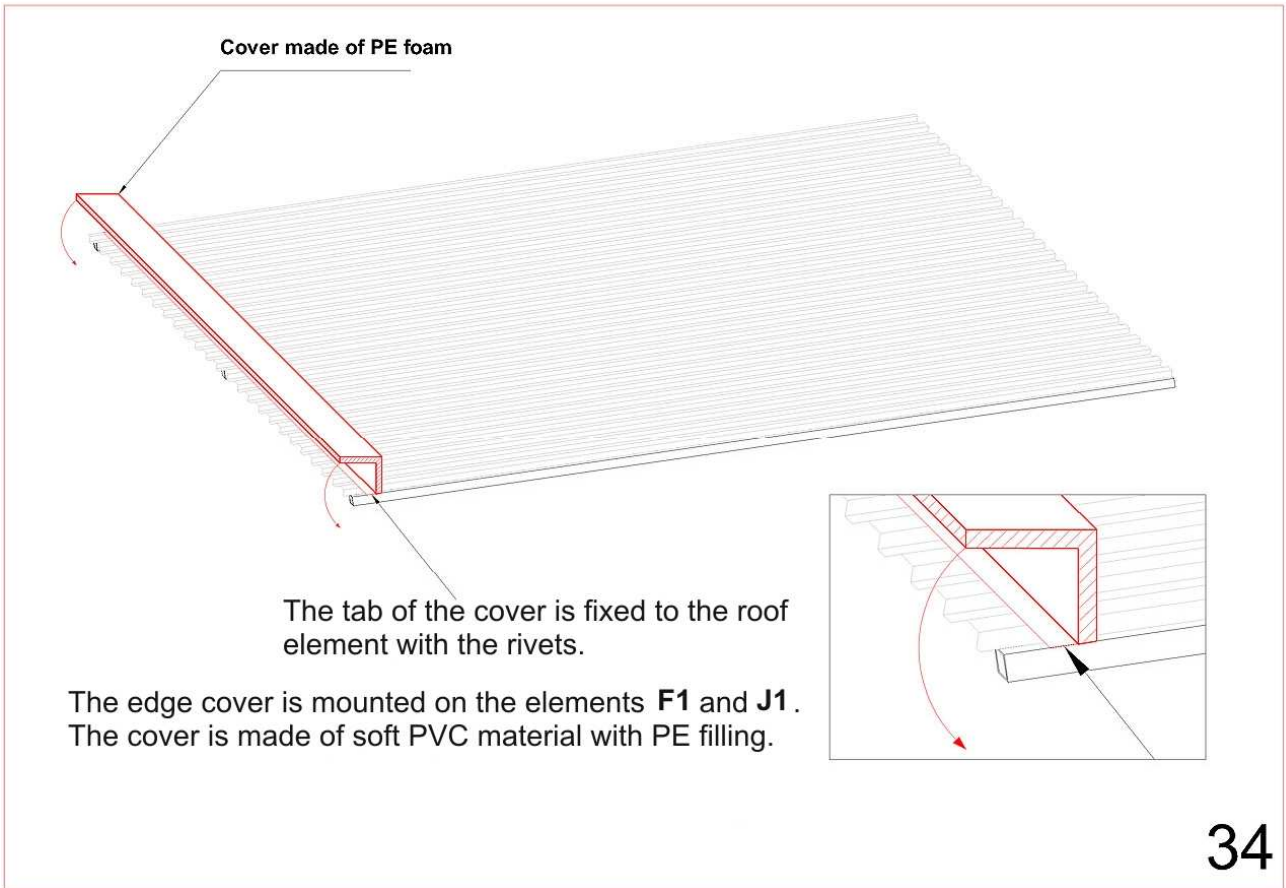

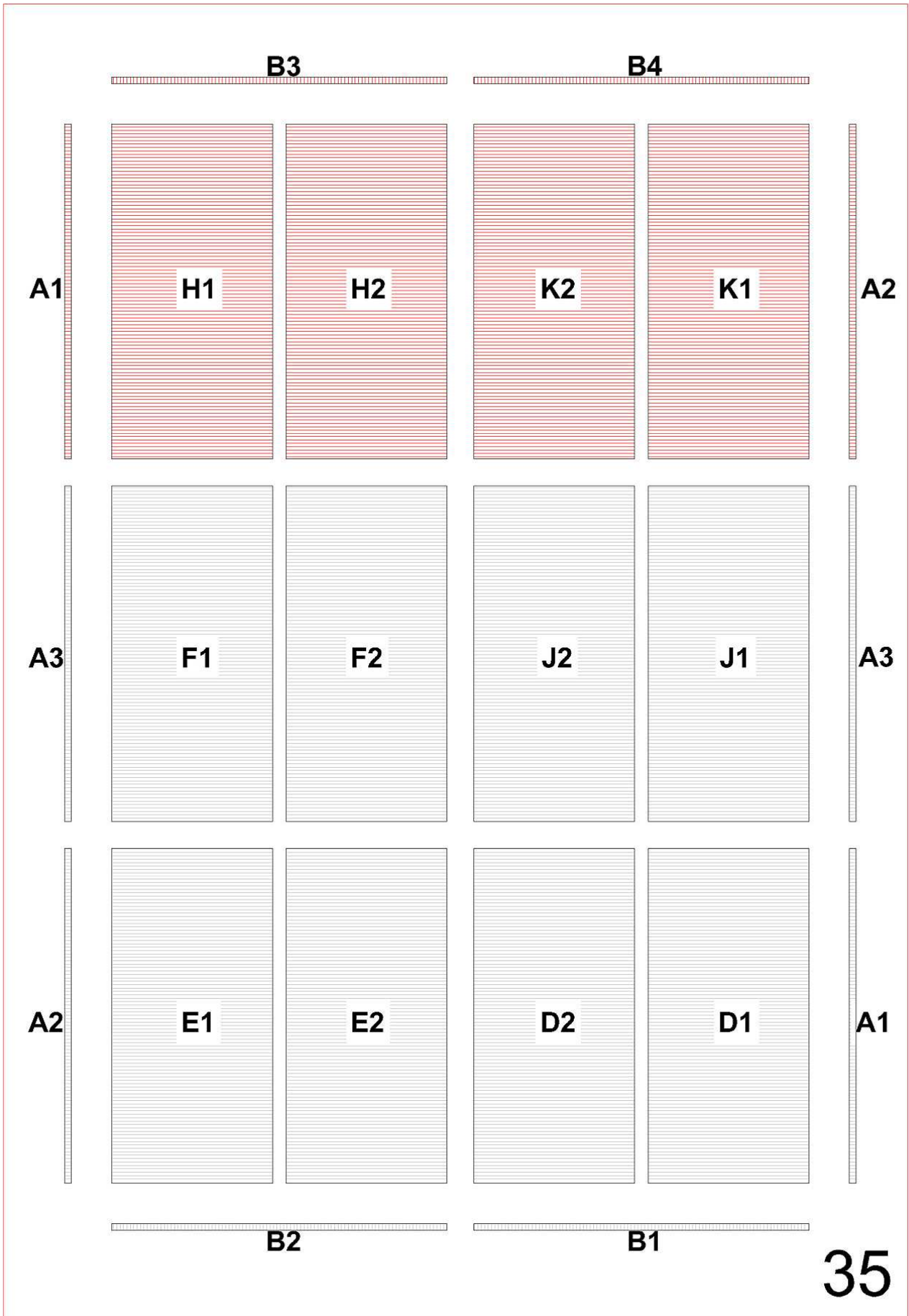

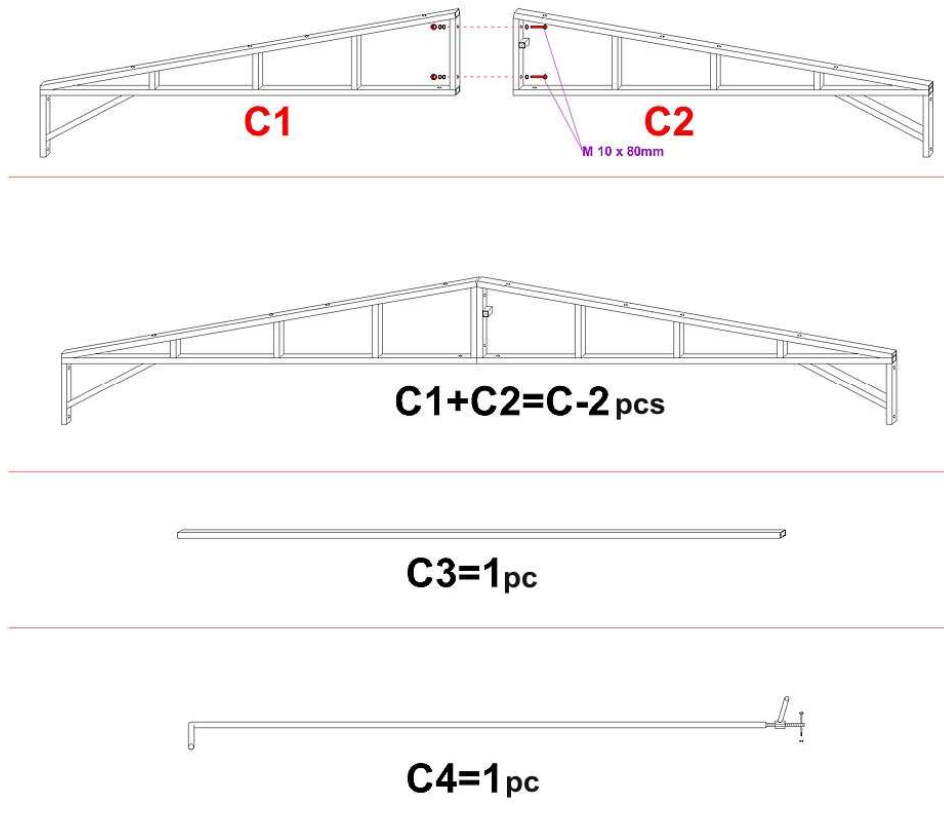

36

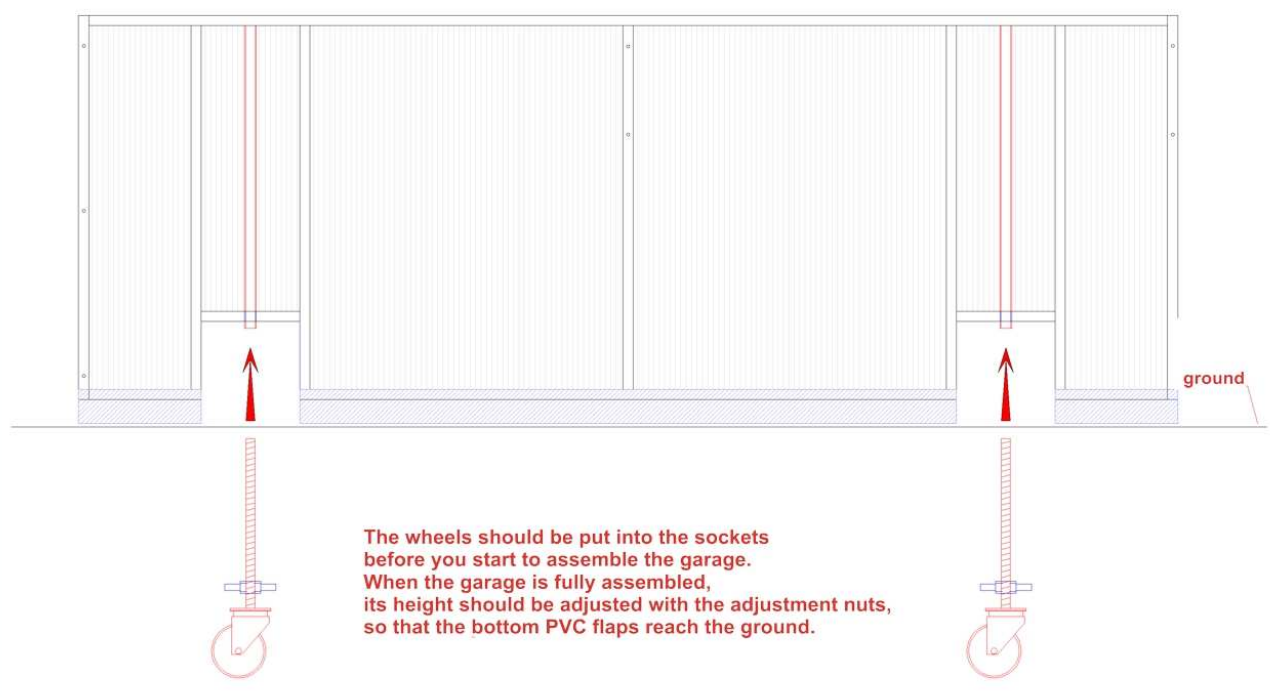

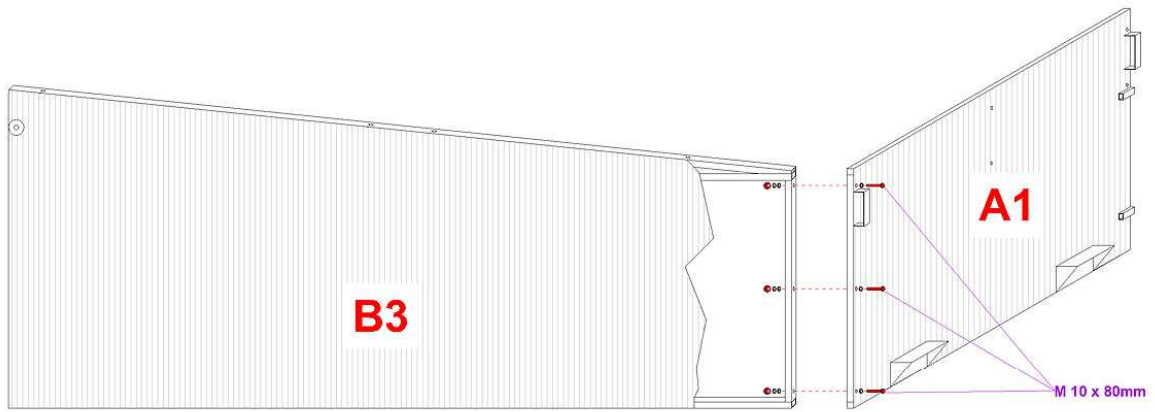

37

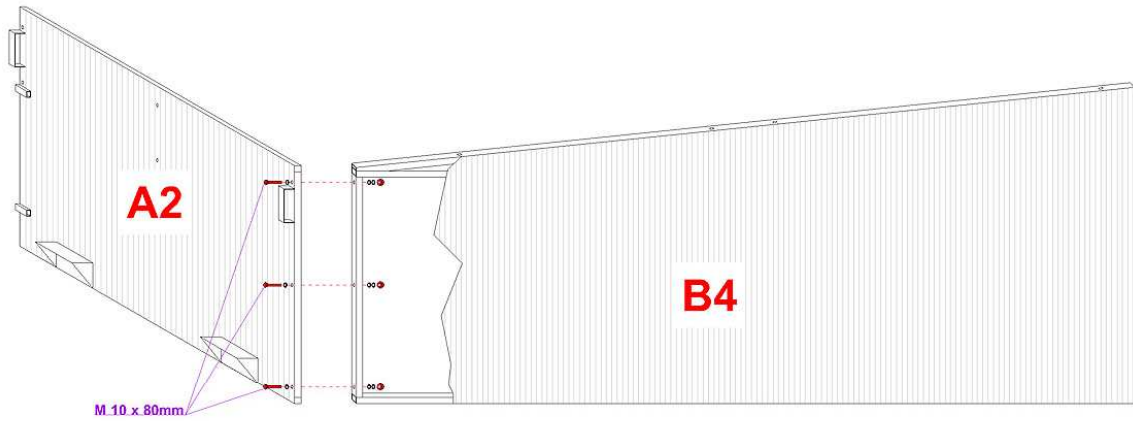

38

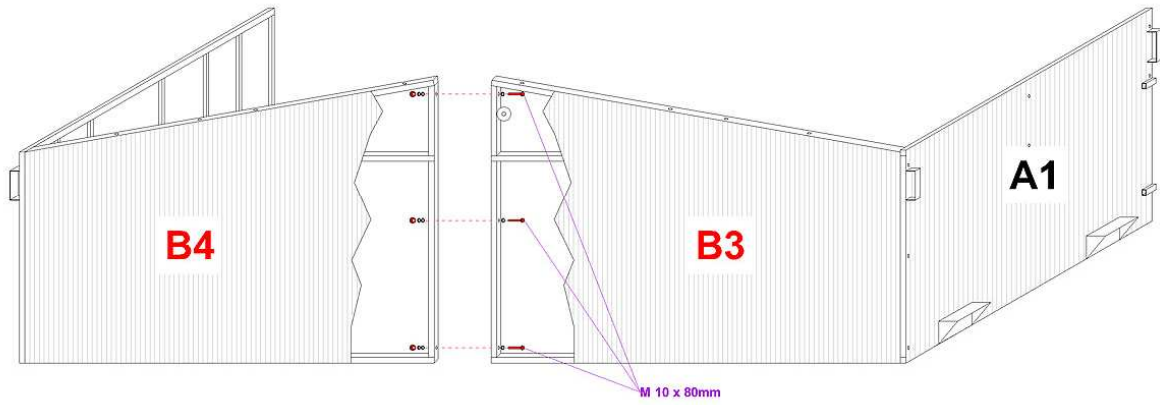

39

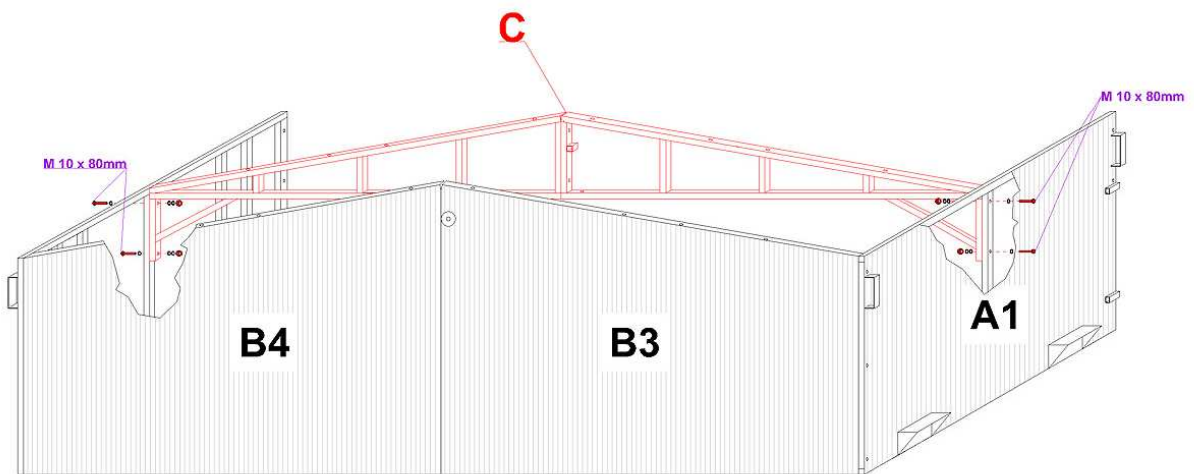
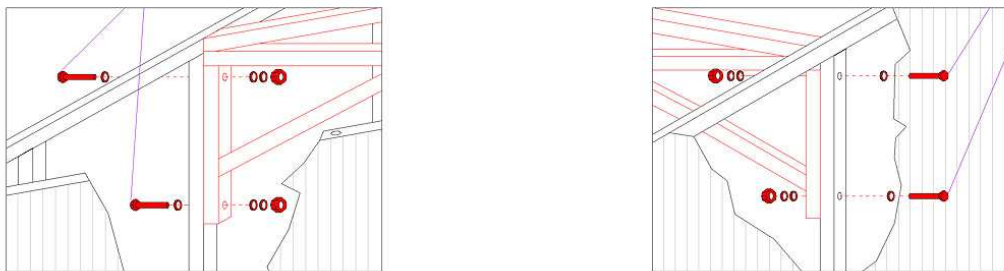

40

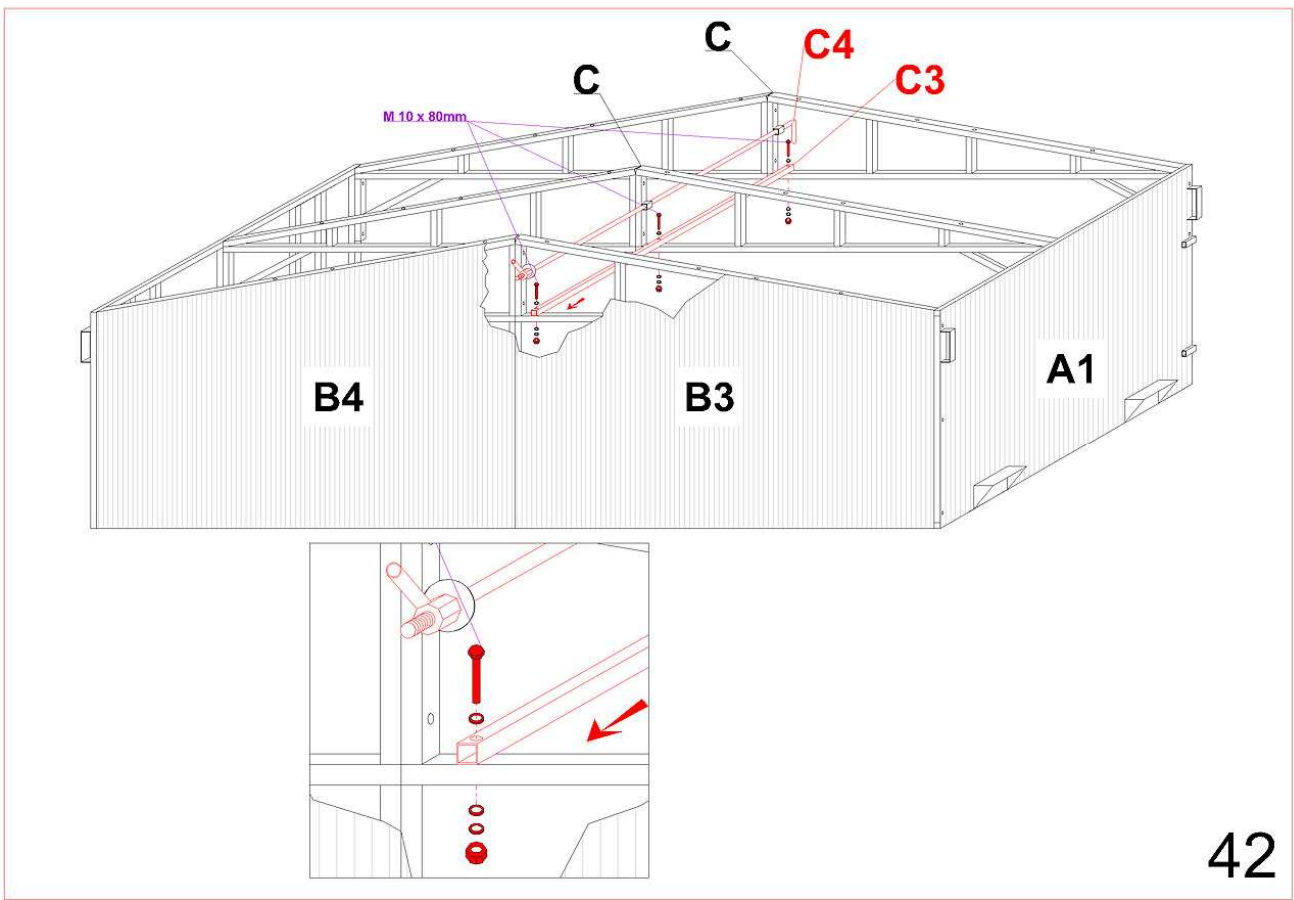
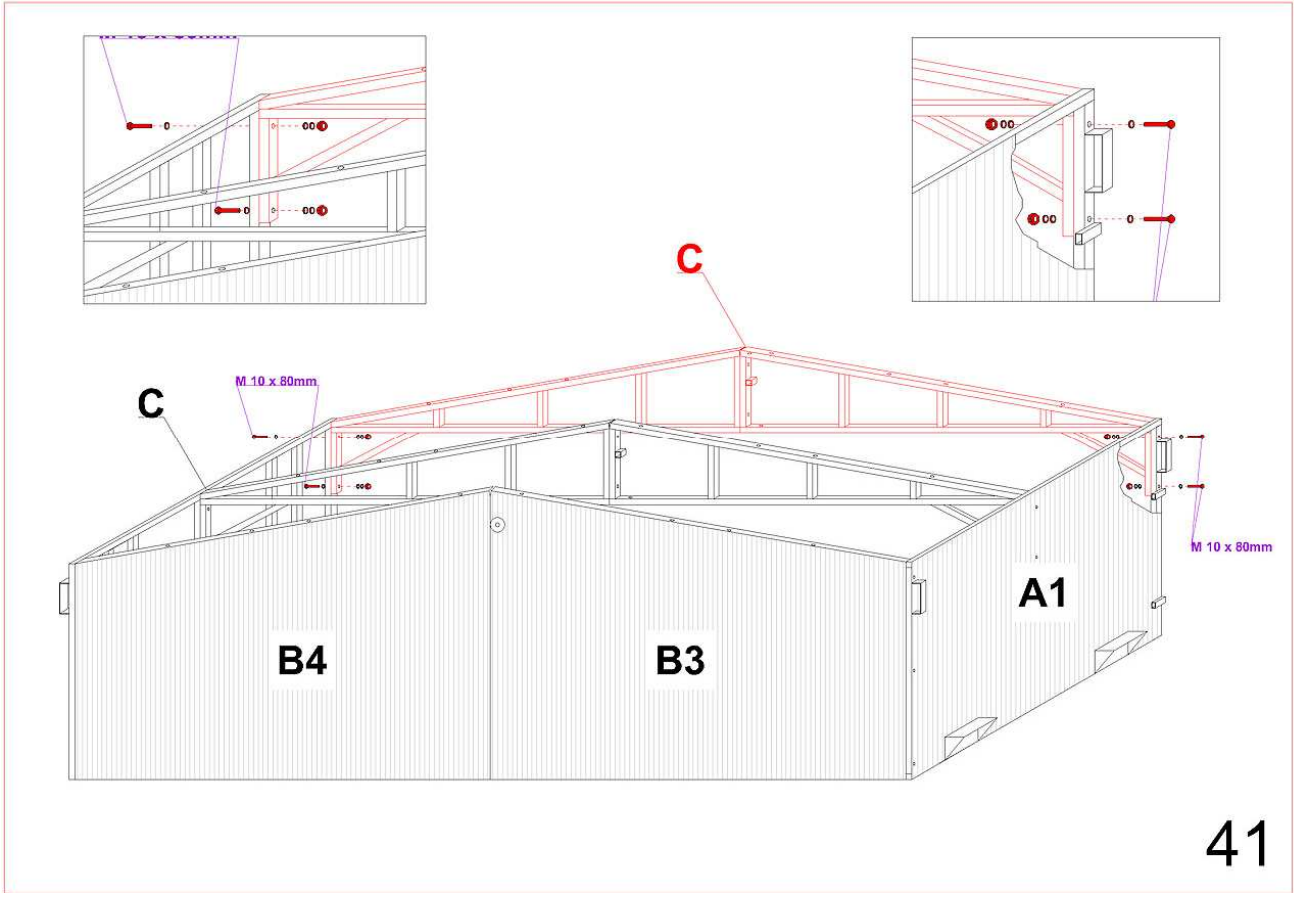

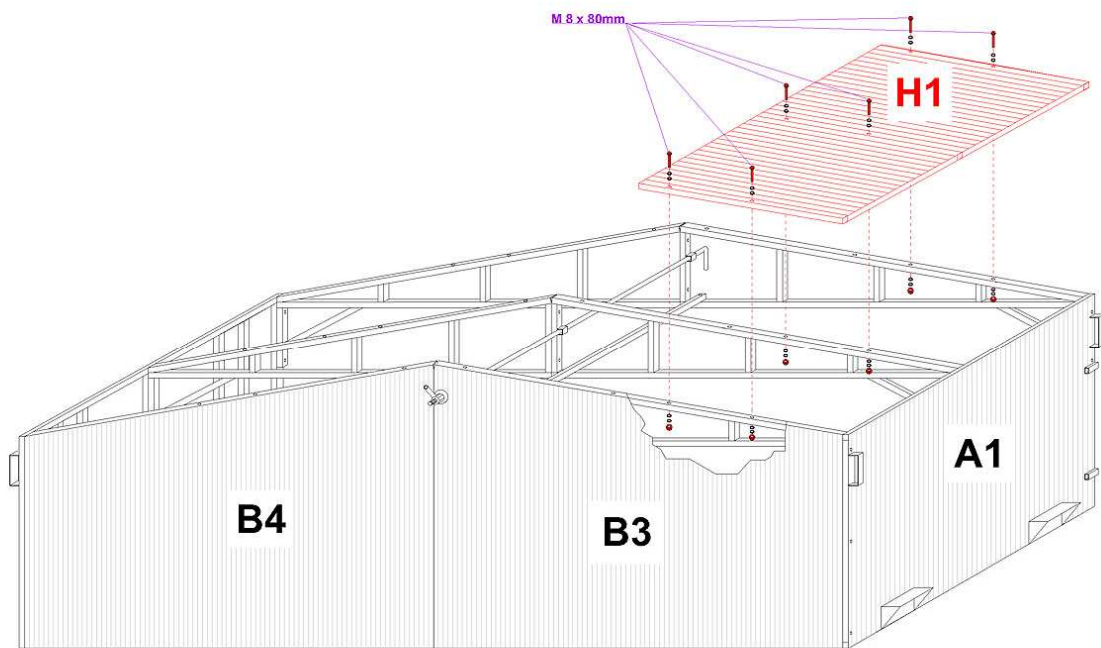

43

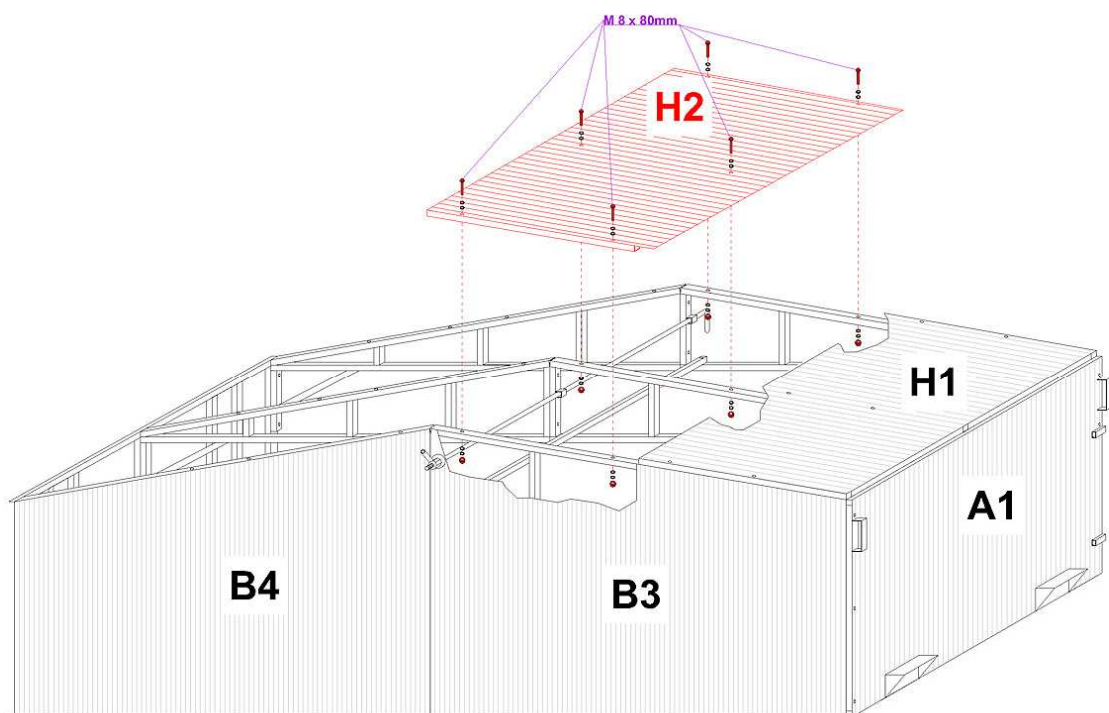

44

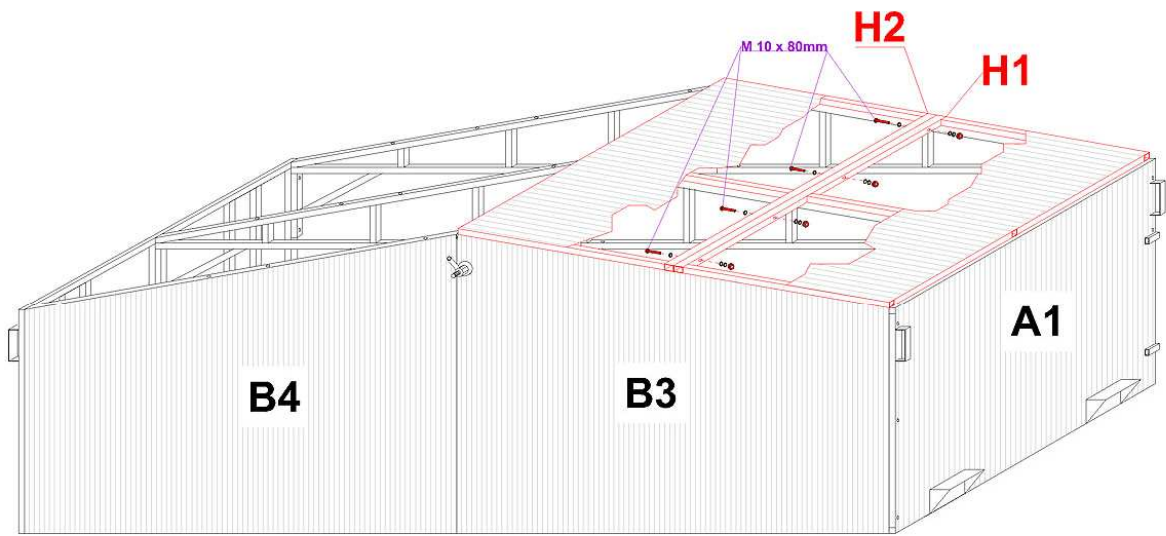

45

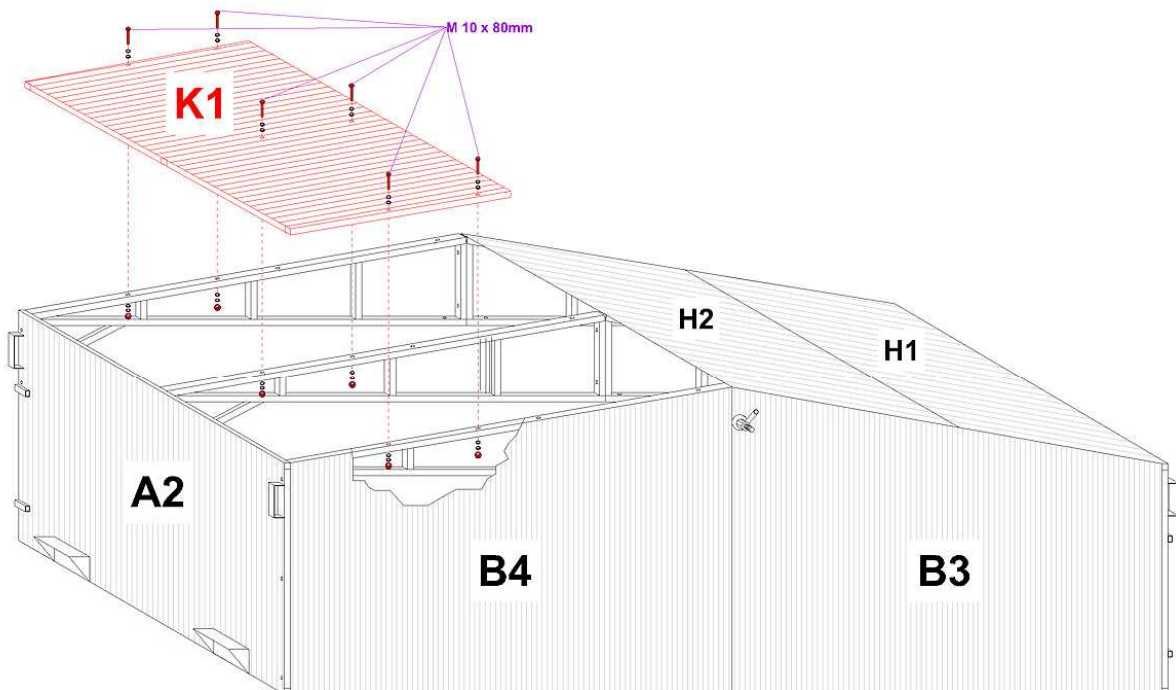

46

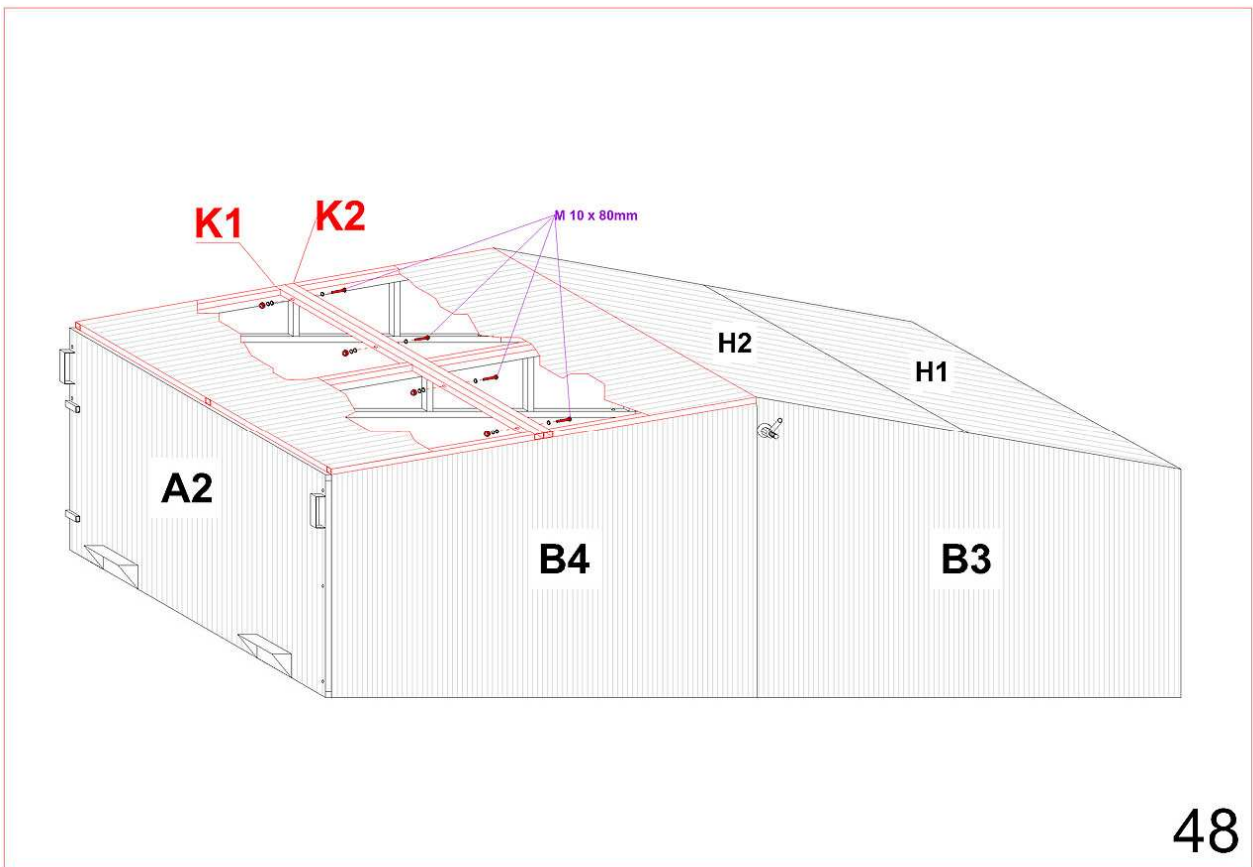
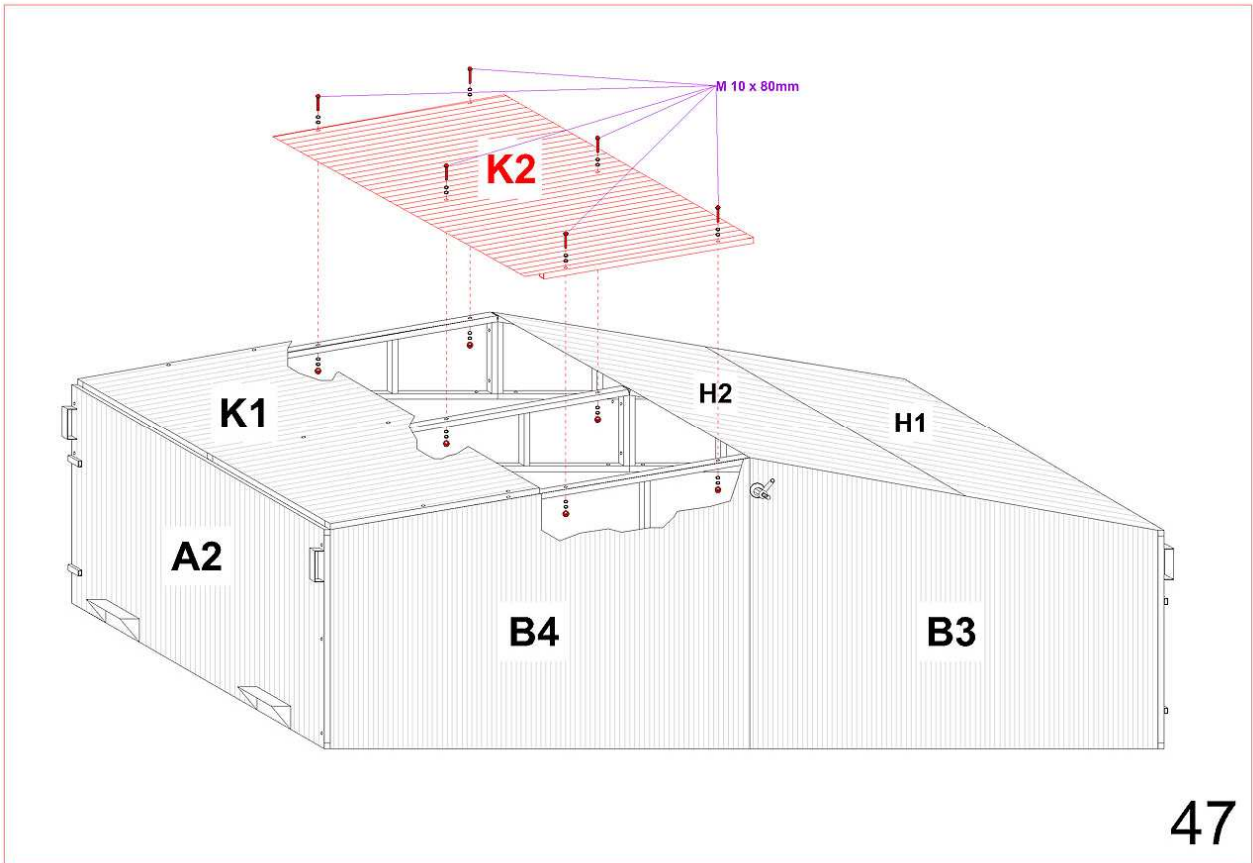

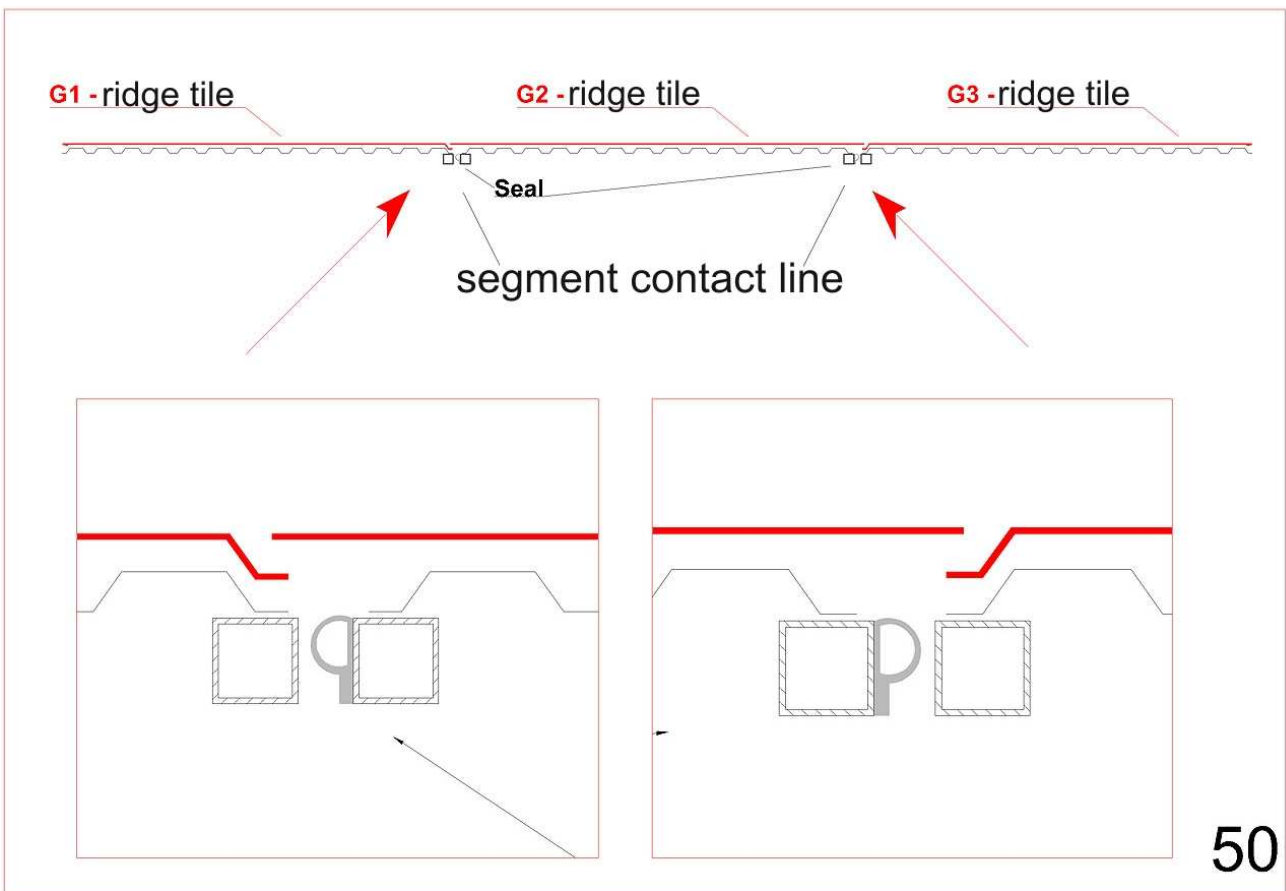
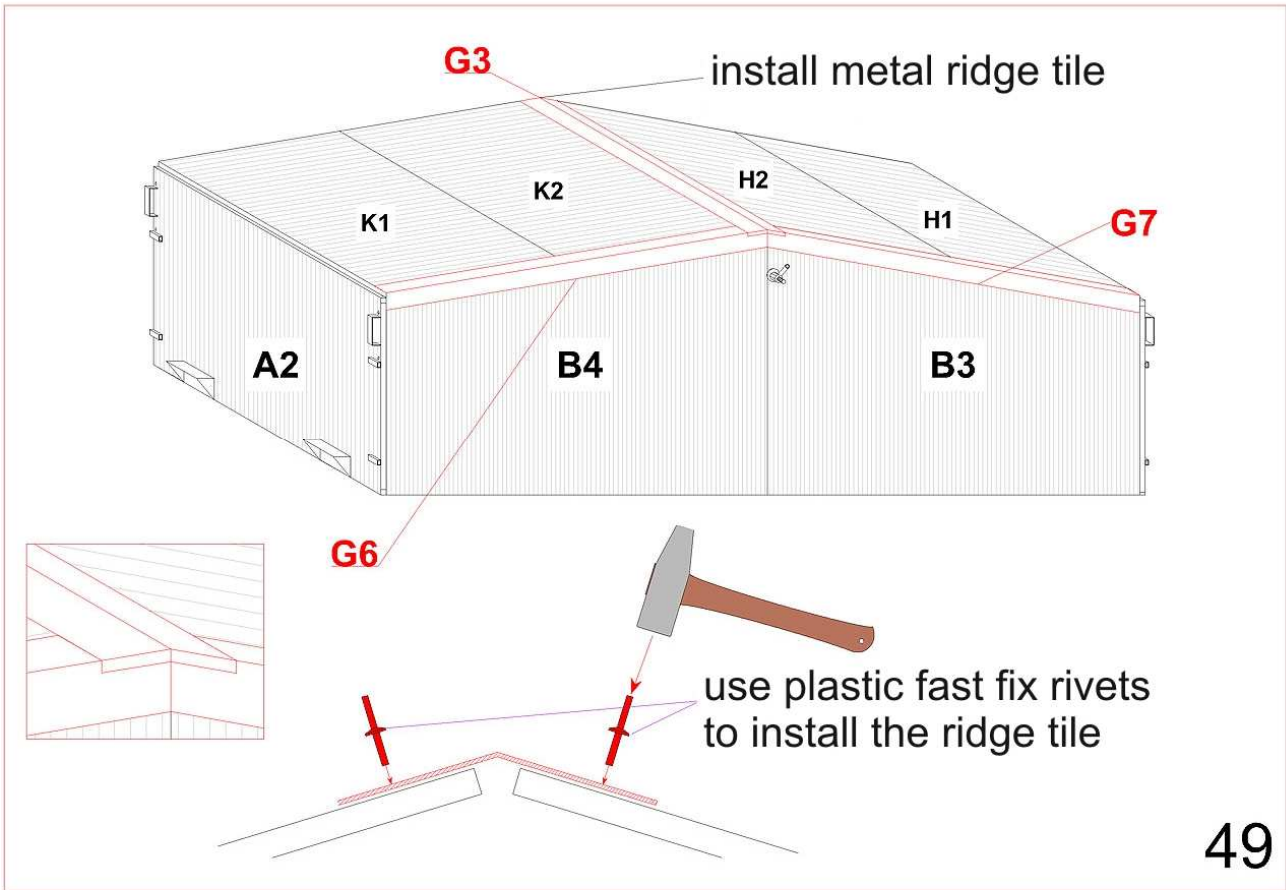

Cover made of PE foam

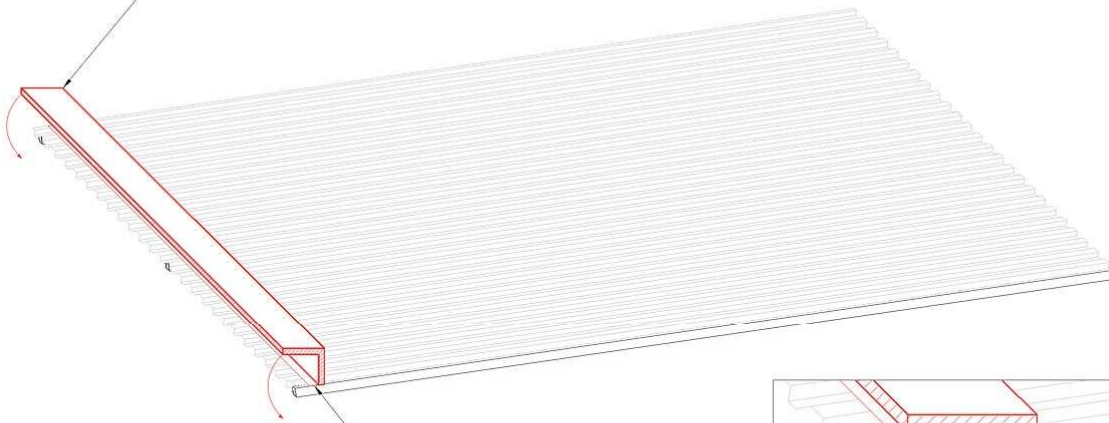

The tab of the cover is fixed to the roof element with the rivets.

The edge cover is mounted on the elements **H1** and **K1**.
The cover is made of soft PVC material with PE filling.

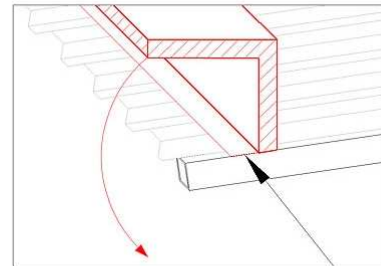

51

SEALING CATCH

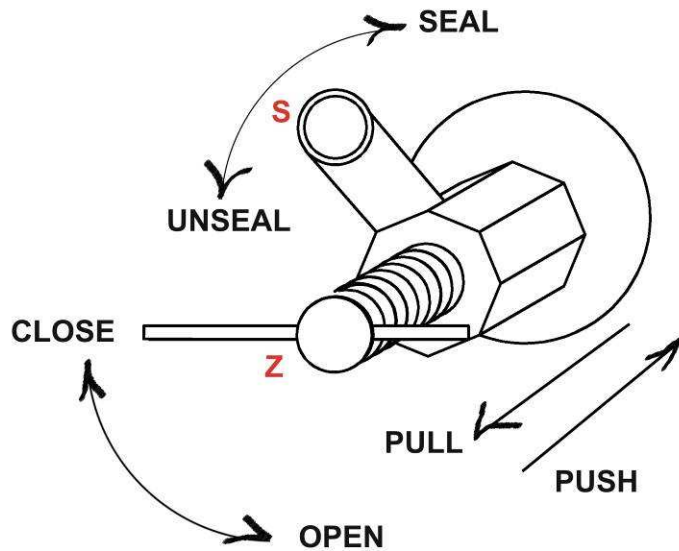

To seal:

1. Open **Z**
2. Push
3. Close **Z**
4. Pull
5. Seal **S**

IV. Operation

While manoeuvring the garage please avoid dynamic movements, otherwise the castoring wheels may not have enough time to adjust to the direction the garage is pushed and they may damage the synthetic surface. The garage which is always parked in one place for longer times may cause slight recesses in synthetic surface due to weather conditions (high temperatures during summer and low during winter) that is normal wear and tear. The garage protects the landing area provided that the landing area is always sheltered with the waterproof cover and positioned on the platform.

V. Maintenance

Always remove snow from the garage roof during winter.

Even the best technical solutions cannot substitute for common sense. Operating sports equipment should be taken place under qualified staff supervision. The producer shall not be liable for any incidents caused by improper assembly or misuse.